

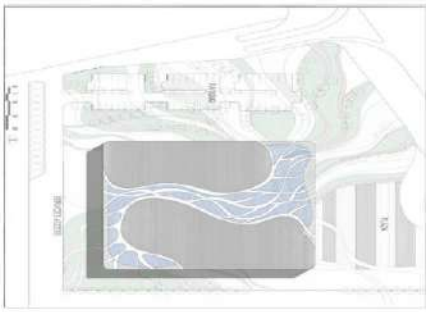

RAYA ANI
RAW-NYC ARCHITECTS



RAYA ANI | RAW- NYC ARCHITECTS  THANK YOU



ASPIRE SPORTS COMPLEX DOHA, QATAR
RAW-NYC ARCHITECTS. DESIGN DIRECTOR: RAYA ANI

The concept of the Sidra tree is expressed in the ever-expanding trunk, roots and branches connecting all aspects of the building inside and out. The roof, facades and the interior are woven together by the growth of the tree trunk and branches, which in turn support the structure. The two soccer field courts are placed within a square volume where light is filtered between the branches of the roof, providing an experience similar to lying underneath a tree.

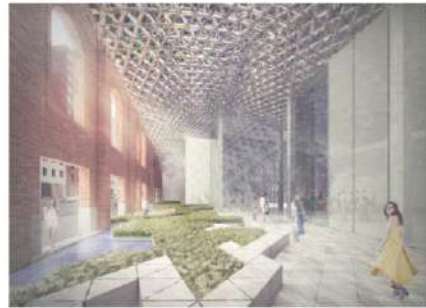
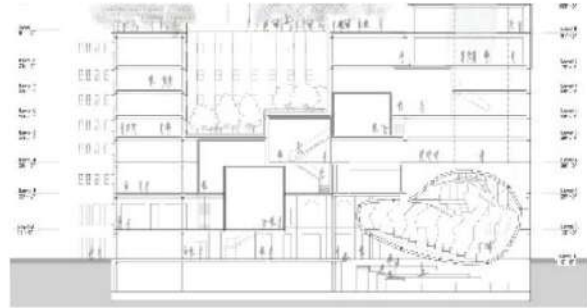
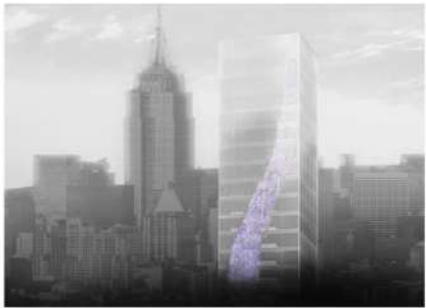

THE WOMEN'S BUILDING NEW YORK CITY, NY
RAW-NYC ARCHITECTS. DESIGN DIRECTOR: RAYA ANI

Respecting the historic character of the remarkable Bayview Correctional Facility building, we plan to maintain and preserve the building's presence and unity on the street, yet build a transparent new presence in the new tower arising out of the existing facade. We envision a series of new spatial experiences that connect all floors. It starts by welcoming everyone into the new groundscape, weaving the experience from the ground floor all the way to the "Head in the Clouds" rooftop space to the vertical interactive spaces in the tower all the way to the top.



BAMIYAN CULTURAL CENTER BAMIYAN, AFGHANISTAN
RAW-NYC ARCHITECTS. DESIGN DIRECTOR: RAYA ANI

An international competition conducted by UNESCO. The main emphasis is the revival of the local crafts & techniques where people will be trained in various skills, crafts & traditional handwork. The center will be a key area where cultural programs & events such as films, dances, music & other shows will be shown to reflect the culture of the region. This will become a mode of engaging people through the realm of history, culture and community, and to empower people to build their own cultural center to raise awareness on Afghanistan's cultural heritage.





RAW WRAP DUBAI, UAE
RAW-NYC ARCHITECTS. DESIGN DIRECTOR: RAYA ANI

RAW WRAP is a 21-story residential building with retail on the ground floor, one level of podium parking, and one level of basement parking. The WRAP being the main design feature of the project, allowed us to maximize the use of outdoor space to create a whole new experience that defines the vision of this residential development. The building mass is split and angled to face the open views on the north west side while overlooking the swimming pool located on the west side of the WRAP.



AYAZ VILLA DUBAI, UAE
RAW-NYC ARCHITECTS. DESIGN DIRECTOR: RAYA ANI

AIZ is a family villa designed for a private client. The massing consists of 4 rectangular blocks with each block slanted in a different direction. The program of the villa starts from the most public functions on the west side to the most private functions on the east side of the site. The design celebrates the relationship of the interior spaces to the exterior by framing the views out to the courtyards that run from West to East, allowing all living spaces to stretch its large windows along them.



AMH TERRACES DUBAI, UAE
RAW-NYC ARCHITECTS. DESIGN DIRECTOR: RAYA ANI

MARINA TOWER DUBAI
RAYA ANI | RAW-NYC ARCHITECTS



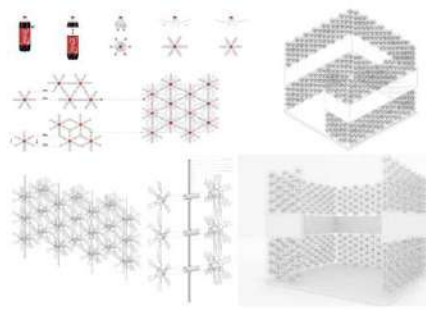

RECYCLED STAND | ZERO EXHIBITION DUBAI, UAE
RAW-NYC ARCHITECTS. DESIGN DIRECTOR: RAYA ANI

Project One: The cityscape stand was built by re-purposing used Coca Cola plastic bottles. The objective was to create a sustainable and innovative solution that was affordable. This empowered our position to be self-reliant and reduce costs by more than 60%.

Project Two: We upcycled the Coca Cola plastic bottles a second time and used it as part of an art installation for the 1971 Gallery space as part of an art piece we created to inspire a sense of infinity and wanderlust. The use of these clear plastic bottles in shapes inspired by botany, comments on the ability to give materials a second life through upcycling.



SONIC UNION, NEW YORK CITY
RAW-NYC ARCHITECTS. DESIGN DIRECTOR: RAYA ANI

Sonic Union, a new audio post powerhouse located in New York City's Union Square, exemplifies the designers iconoclastic sensibility. Instead of dull, square rooms associated with sound studios, an open and casual space filled with light was envisioned. It was also a priority to create rooms where clients would linger and feel at home. In response to these needs, RAW-NYC came up with an "elevated park" design, capitalizing on the audio post house's perch looking down on Union Square Park.



SONIC UNION BRYANT PARK
RAW-NYC ARCHITECTS. DESIGN DIRECTOR: RAYA ANI

Sonic Union on Bryant Park is a sound recording studio referred to as "PLAYGROUNDS". Located in Midtown Manhattan, the epicenter of business with its own ecosystem of interconnected businesses; the designer envisioned interconnecting major landmarks in the neighborhood and bringing this ecosystem indoors. A holding space in the form of a circle in the corner overlooking Bryant Park was reserved. It was intended for this void to be used by different artists at different times for sidewalk 3D graffiti art.



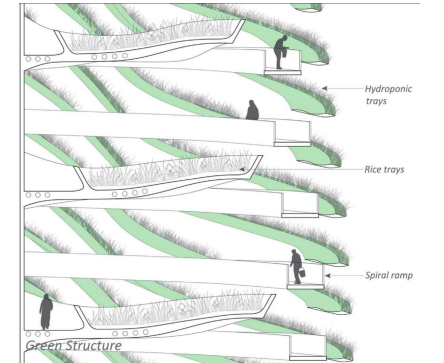
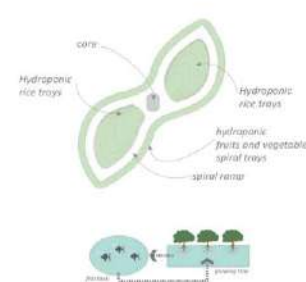
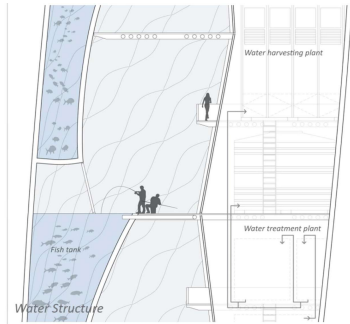
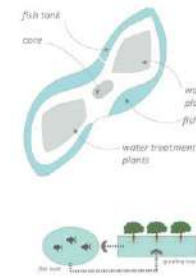
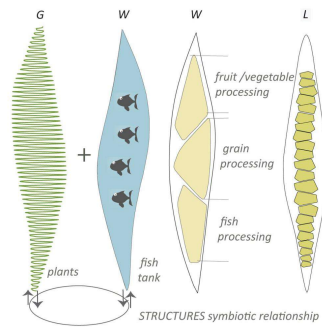
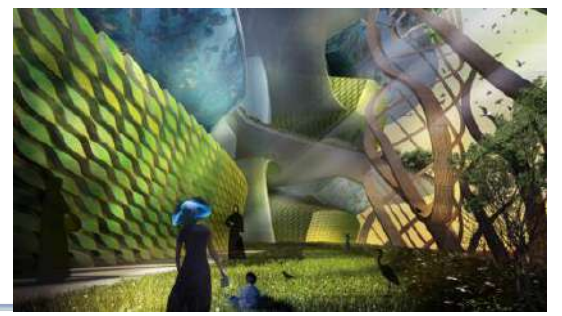
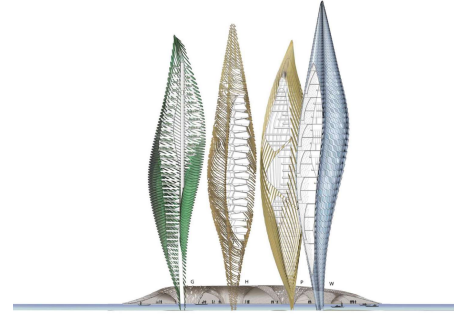
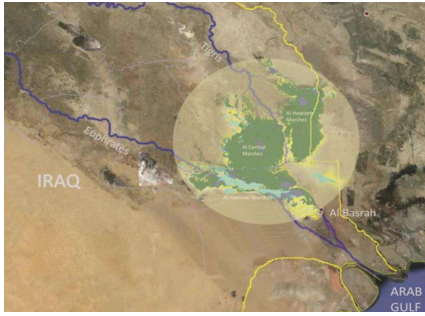

MARSHES OF SOUTHERN IRAQ
RAW-NYC ARCHITECTS. DESIGN DIRECTOR: RAYA ANI

The proposed design intends to provide a conceptual framework to organize the marsh communities of Southern Iraq into a modern and economically viable entity while addressing most critical ecological concerns. While preserving the tradition of fishing and farming, the proposal recommends technologies to produce organic food and potable water, generate green energy, and cultivate fish.

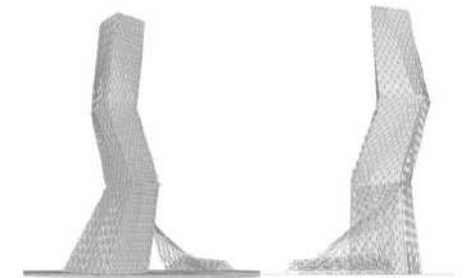
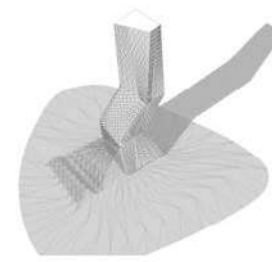
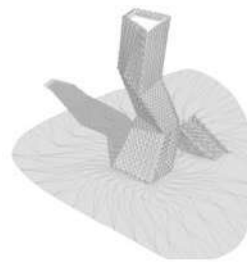
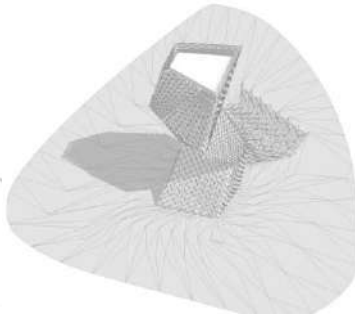
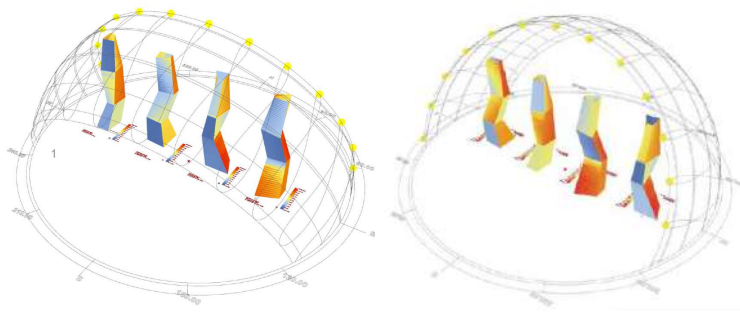

ADAPTIVE OFFICE TOWER DUBAI, UAE
RAW-NYC ARCHITECTS. DESIGN DIRECTOR: RAYA ANI

Research and Design in adaptive Architecture and smart materials for efficiency in energy use, using responsive skin or smart materials; a critical design research for future generations. The intelligent skin of the structure adapts to the sun path and the overall environment. The form of the building is derived from the sun's impact on the tower's form while positioning the tower optimally. The adaptive skin uses technologies that are either manual, using mechanical & electronic sensors or by using technologies like smart materials.

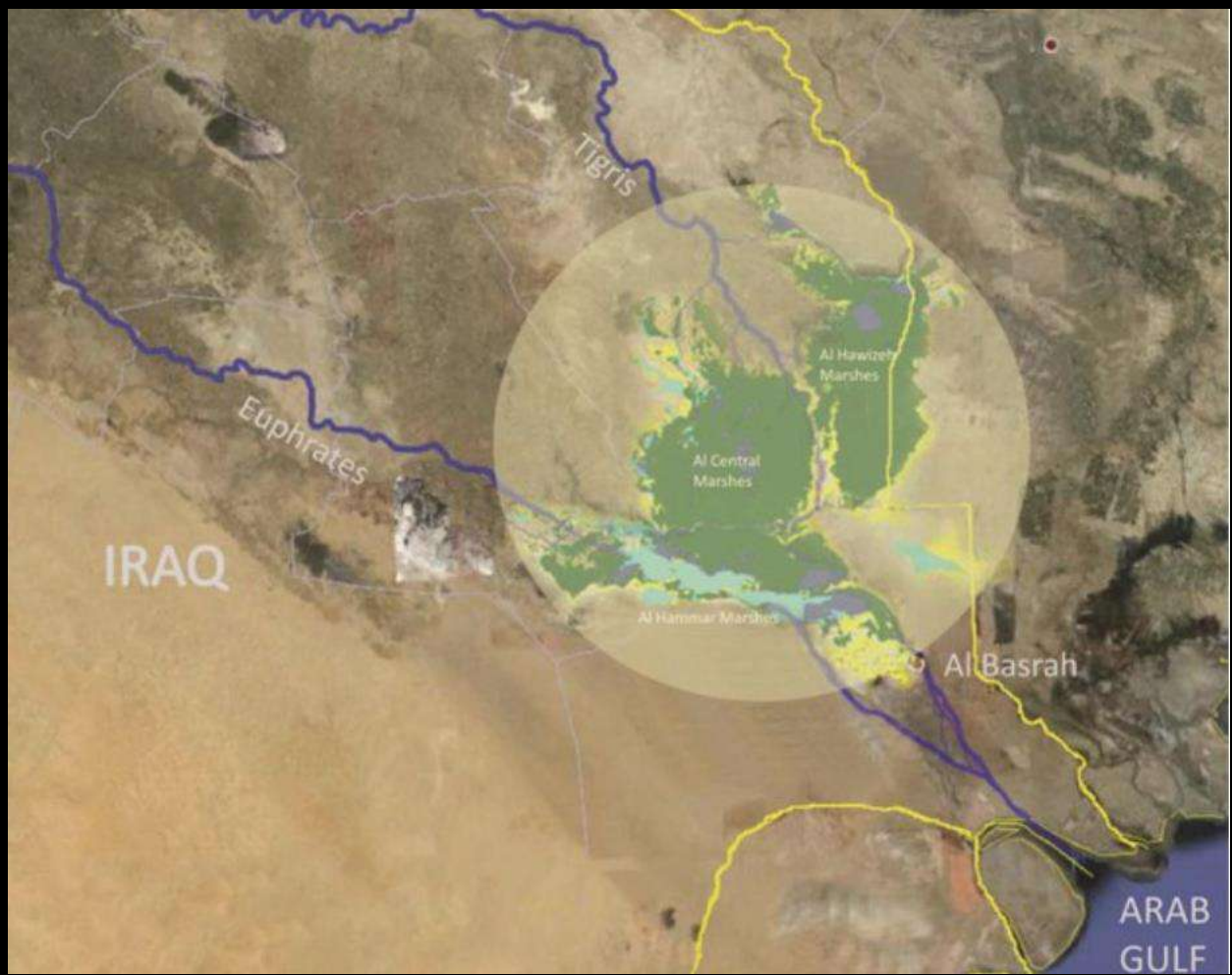





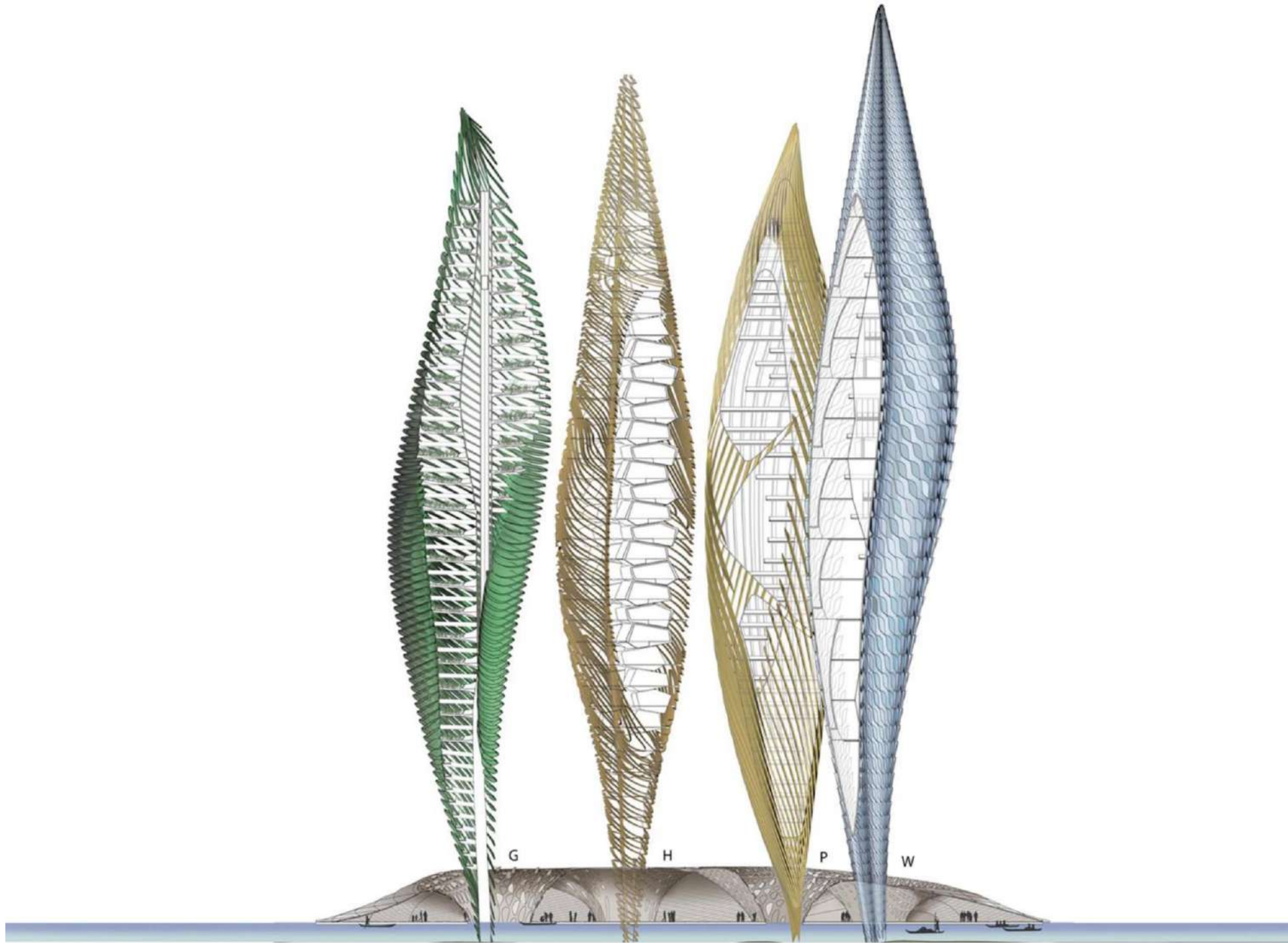

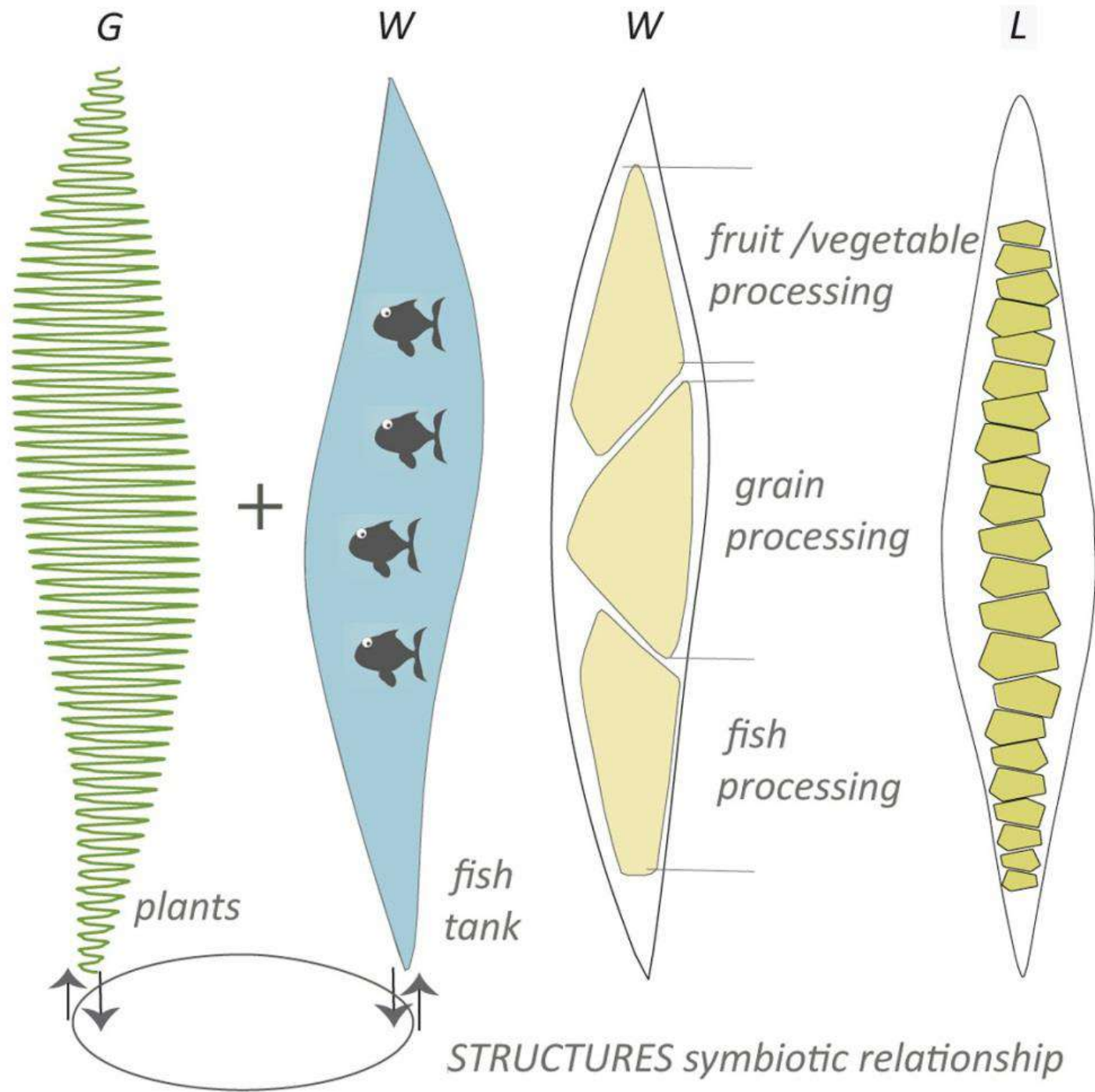

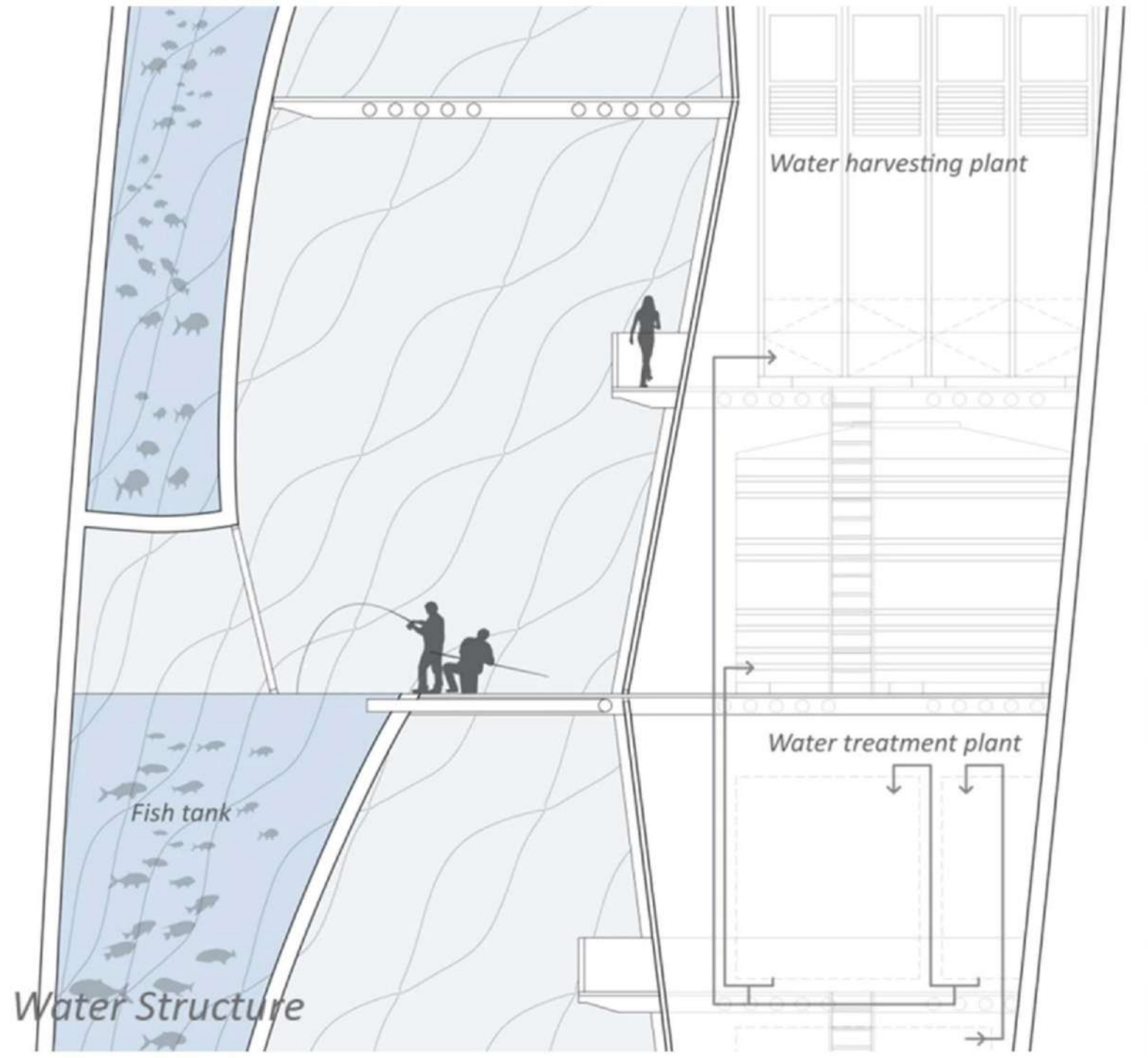

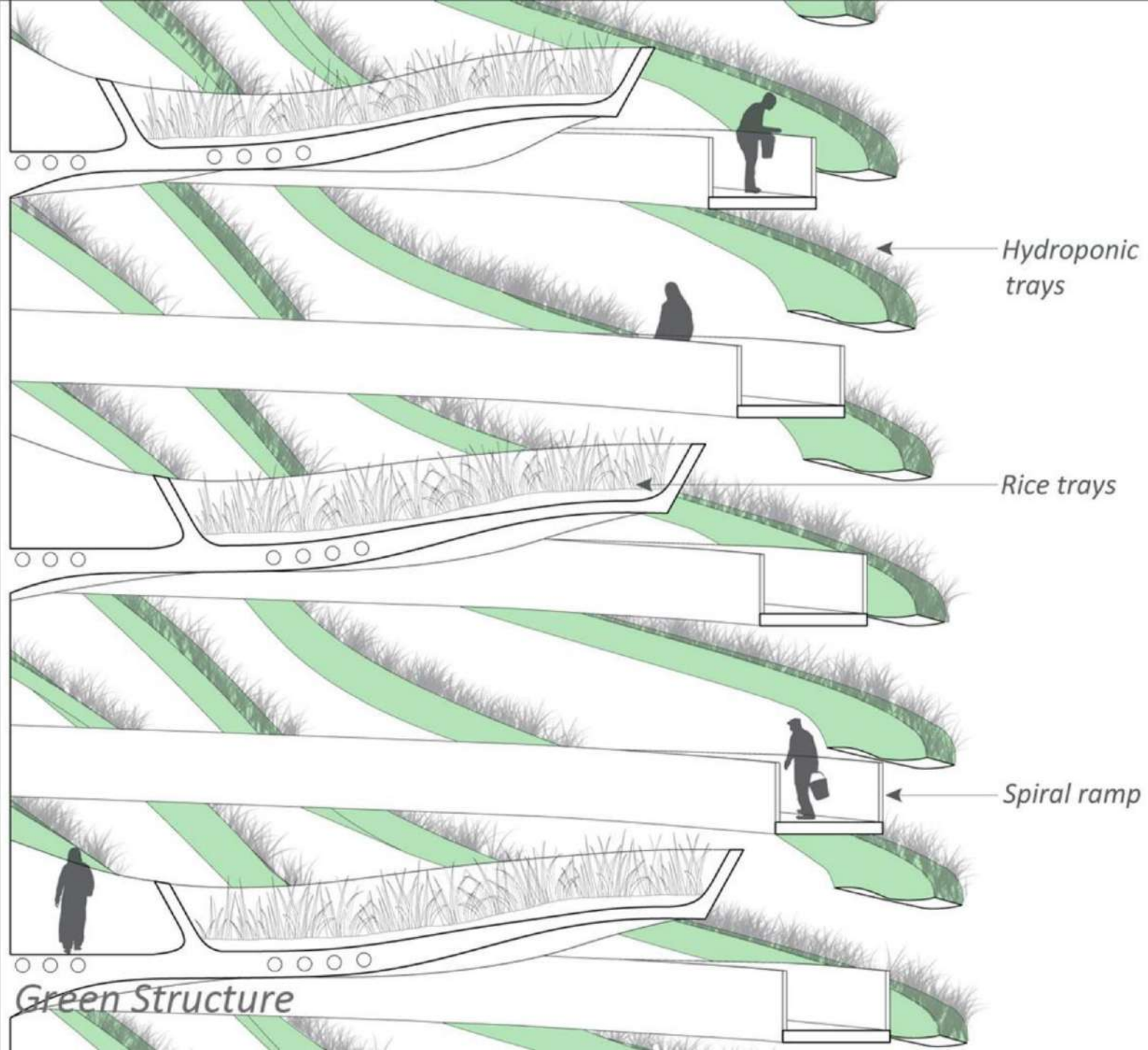



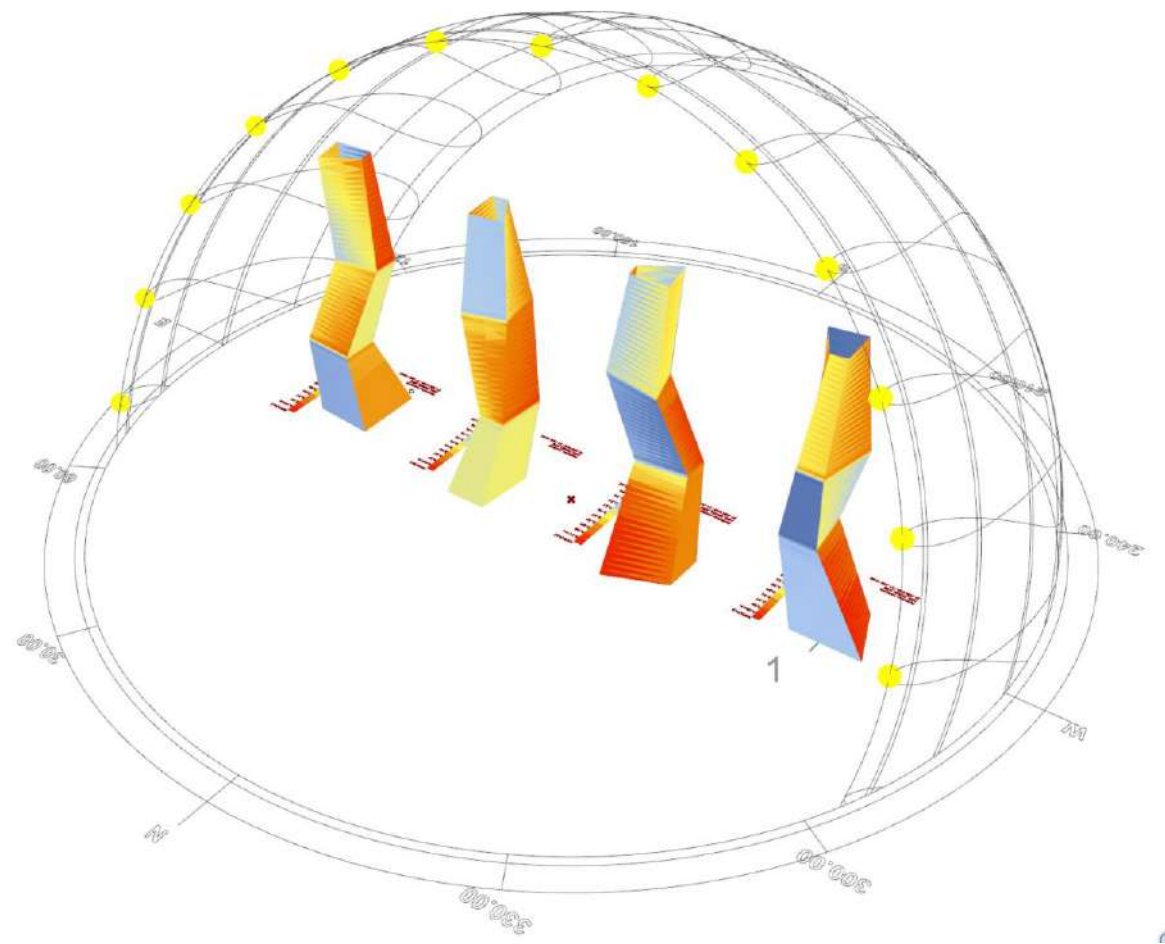
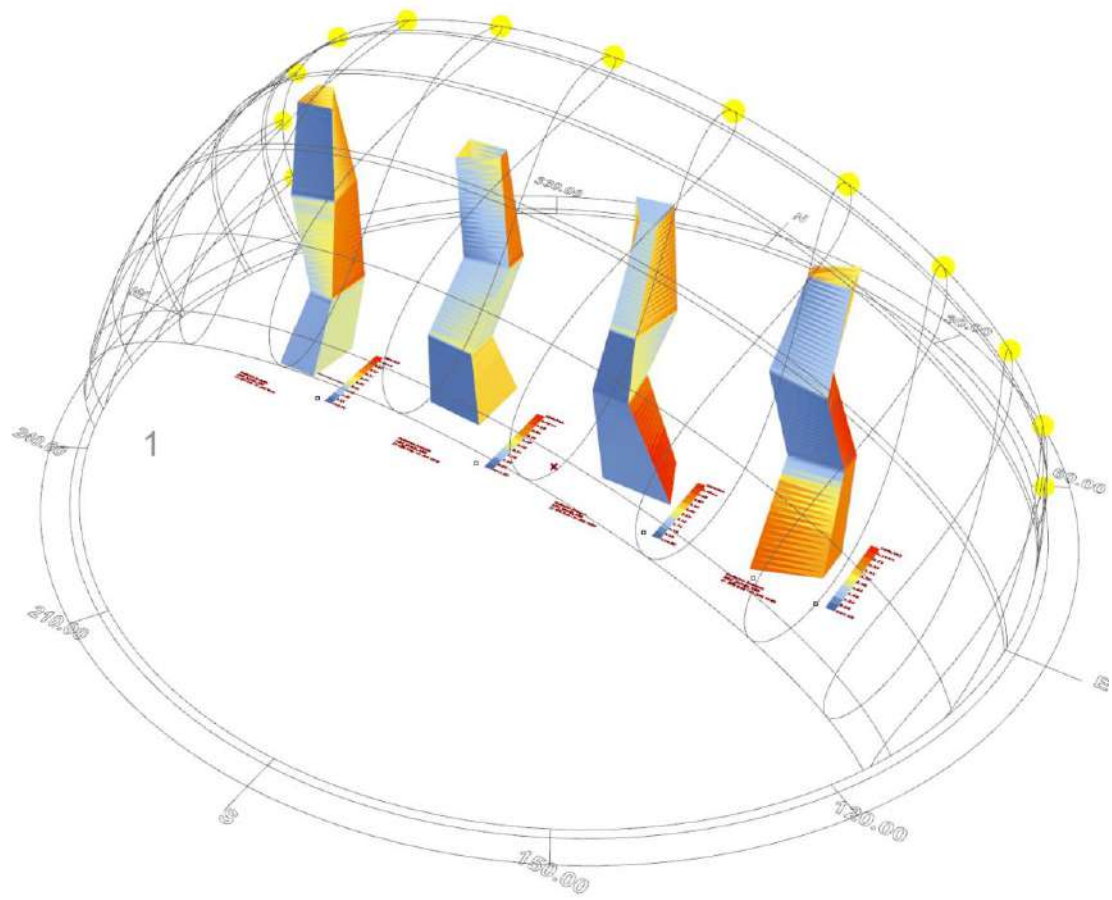

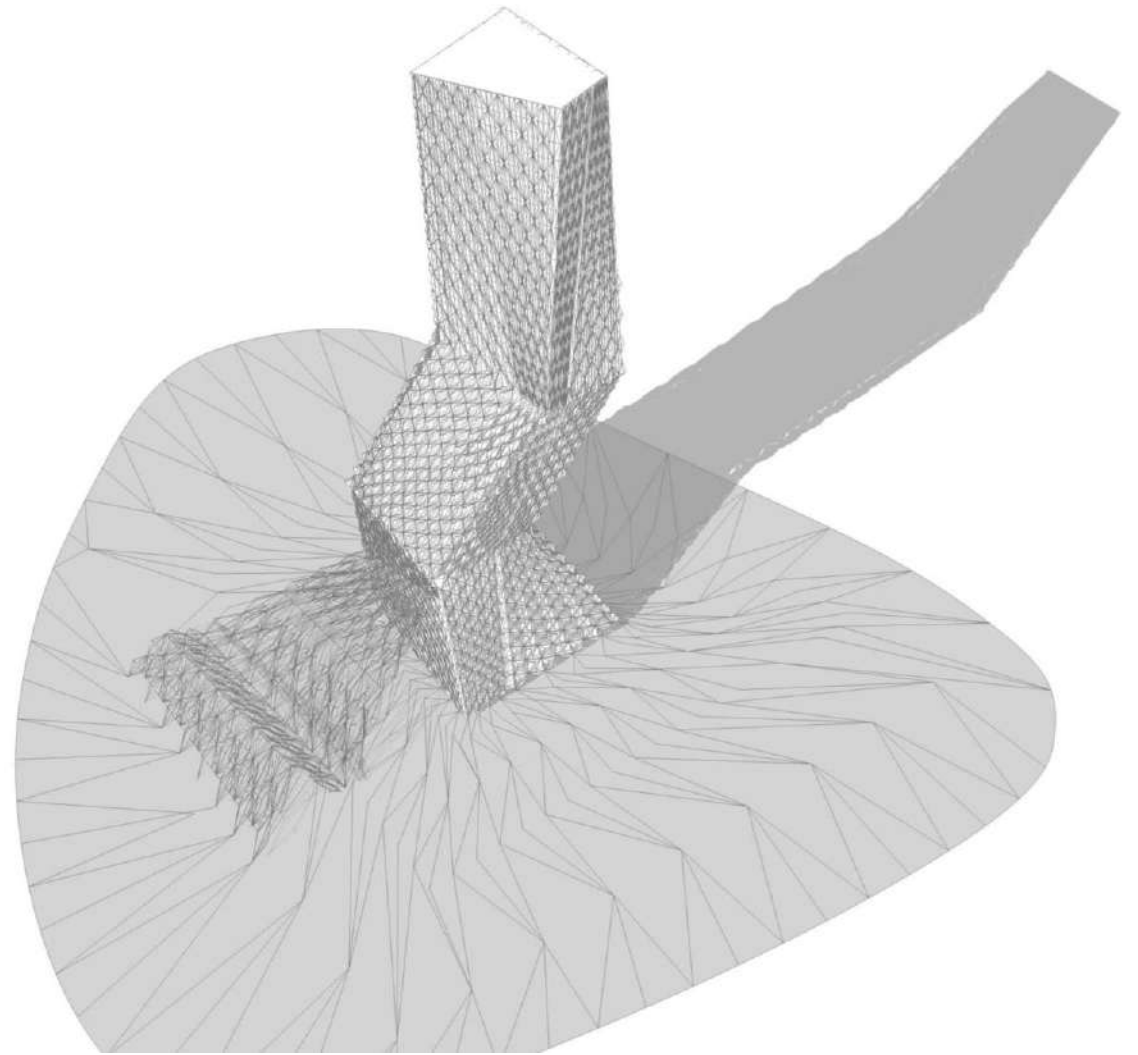
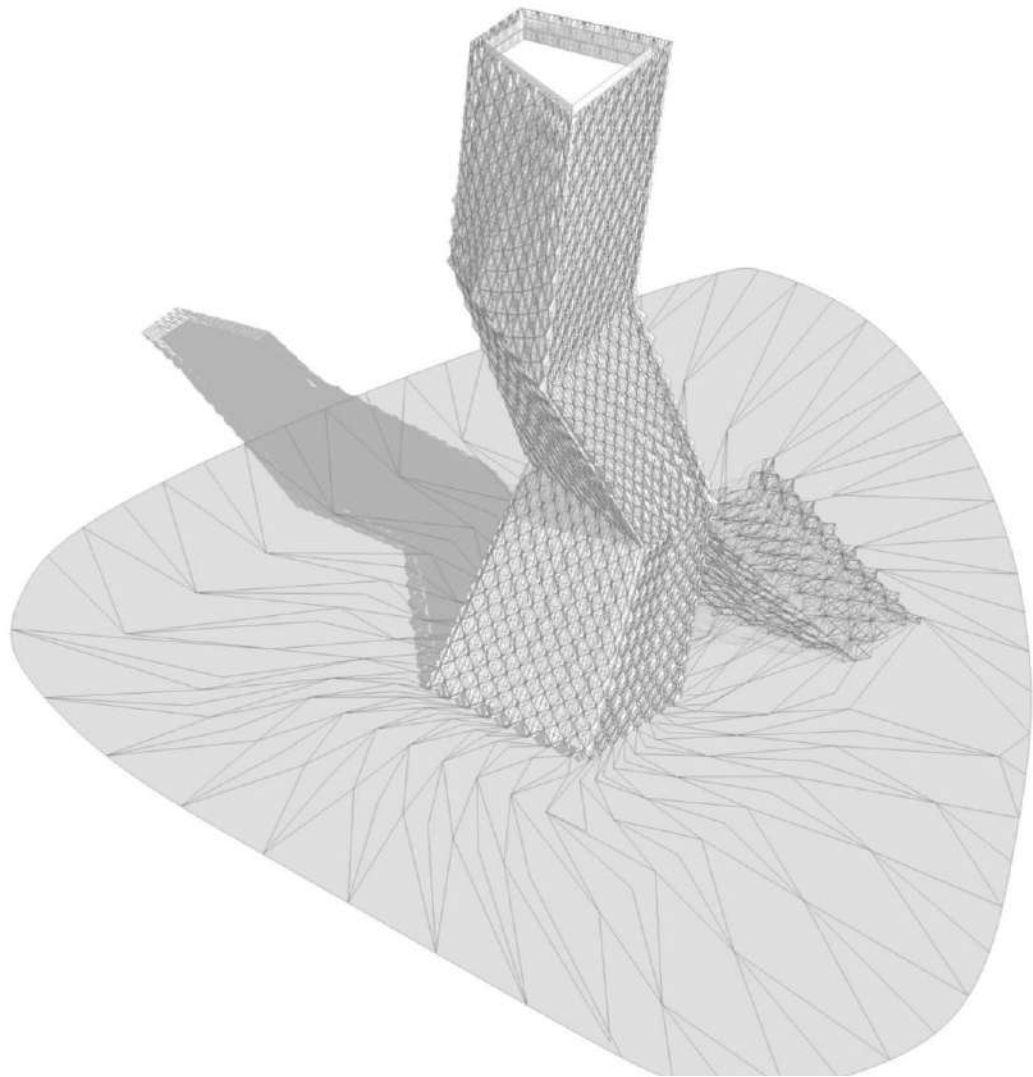

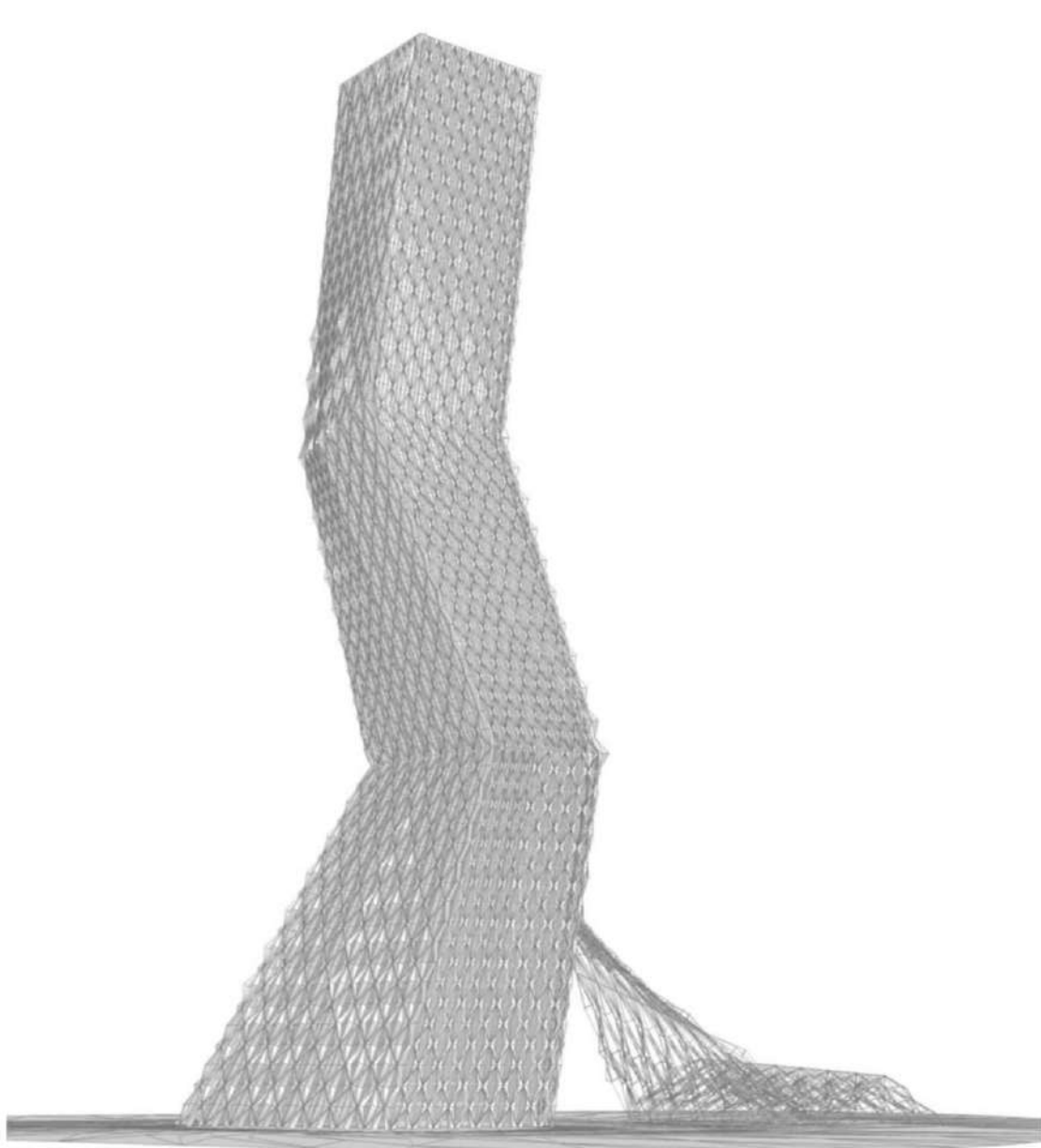

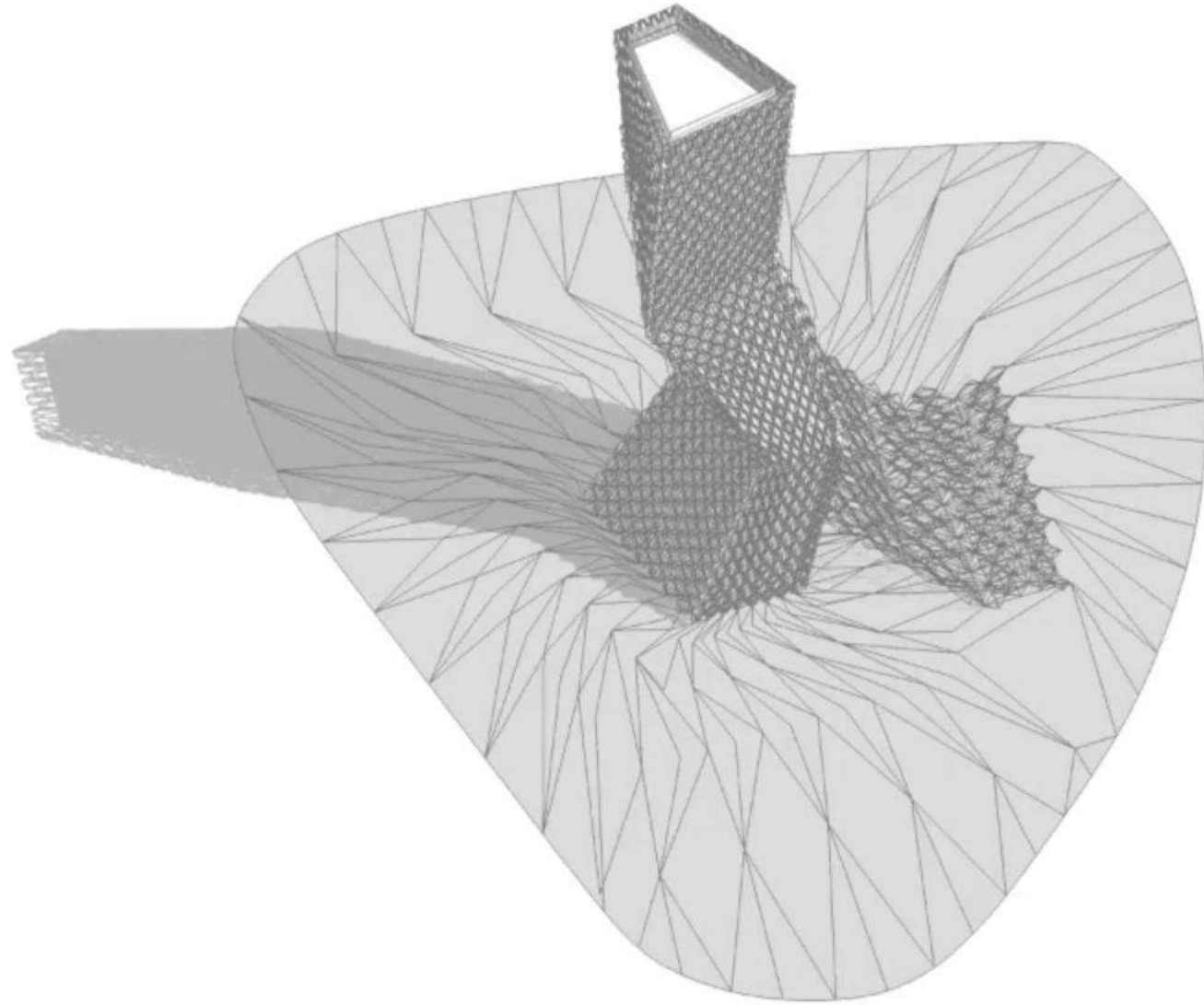

RAW



GUGGENHEIM MUSEUM HELSINKI, NETHERLANDS
RAW-NYC ARCHITECTS. DESIGN DIRECTOR: RAYA ANI

The museum is designed as a series of volumes to address the park and the city on one side and the harbor on the other, complementing the overall cityscape. The peaks and dips of the form are carefully orchestrated to maintain the views. The three carved out volumes: the Garden of the Public, the Garden of Reflection, and the Garden of Sculpture, are the backbone of the museum, where the natural flow of the park travels organically through the museum and to the harbor.

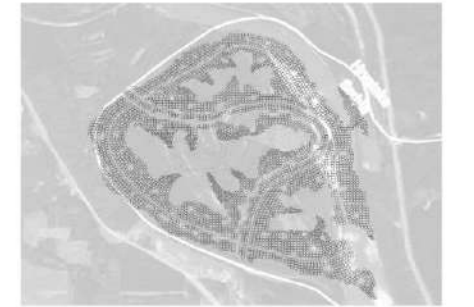
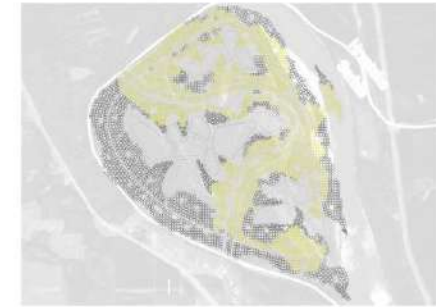
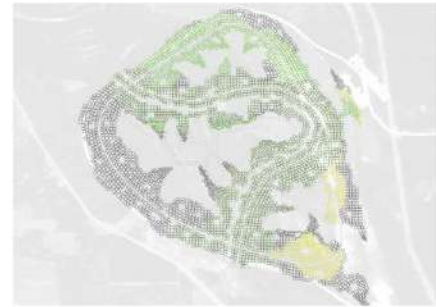
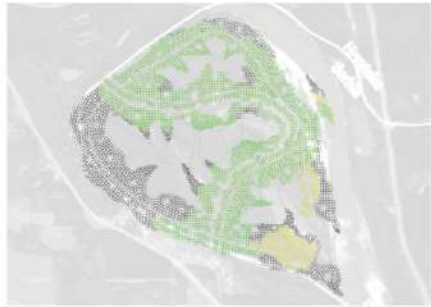
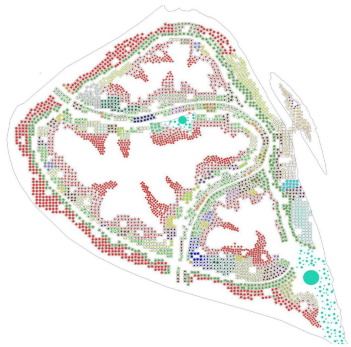

LIBERLAND DESIGN COMPETITION
RAW-NYC ARCHITECTS. DESIGN DIRECTOR: RAYA ANI

The design envisions a micro-nation formed by an open source society that embraces freedom and provides equal opportunities to innovate. A value synonymous with freedom and innovation, safeguards the needs of future generations. The systems of Liberland's built and natural environment are integrated to create unlimited opportunities for its citizens regardless of their ethnicity, race, age, gender or profession, allowing them to reach their full potential and participate collectively in financial gains.











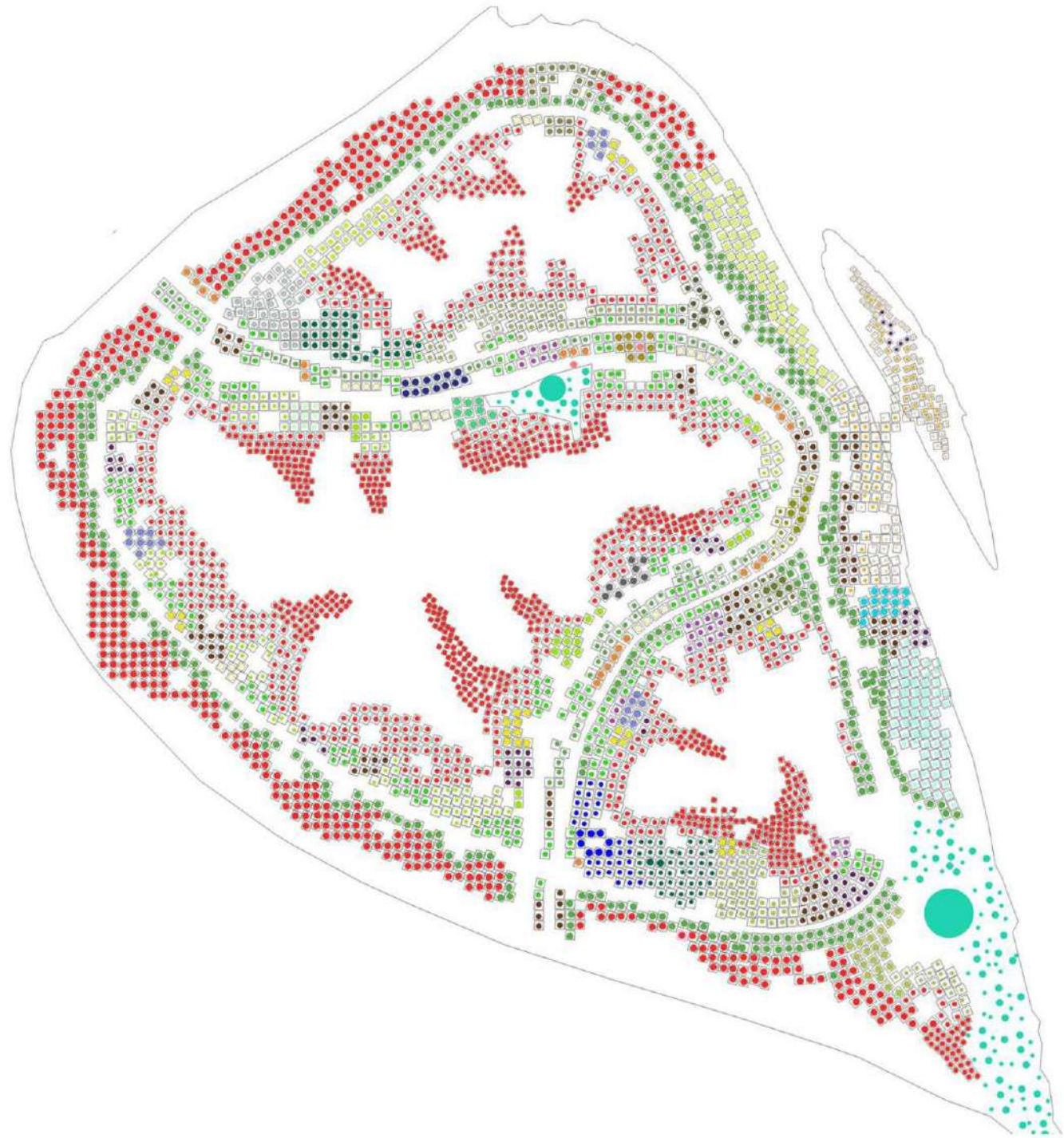







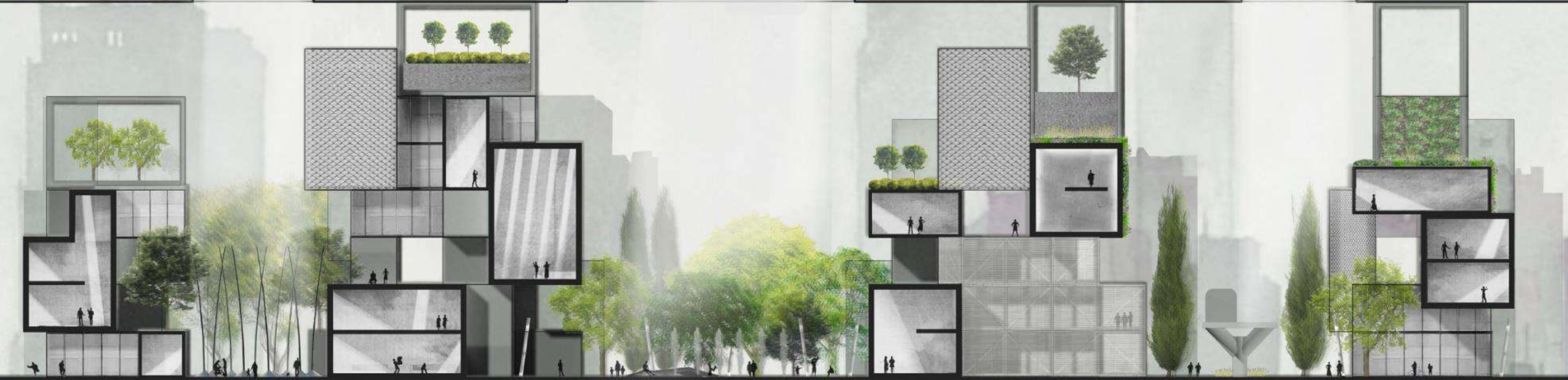

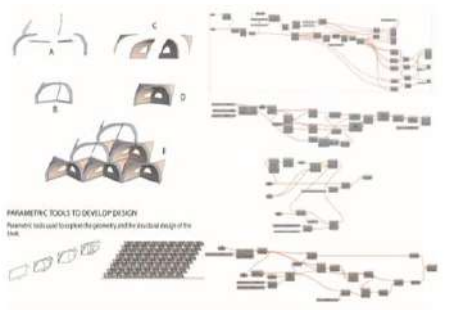
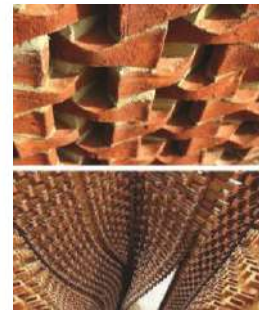
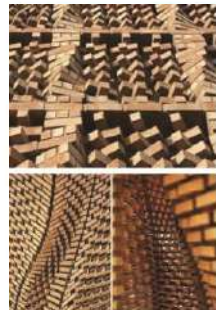
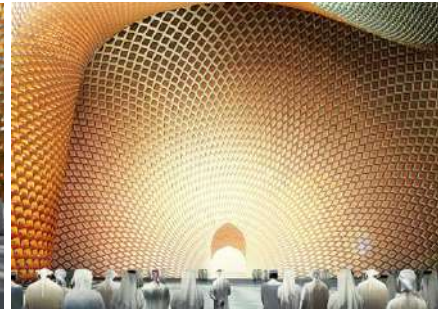
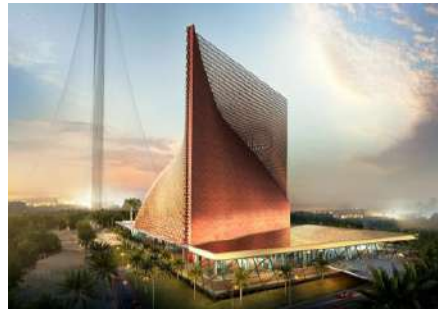
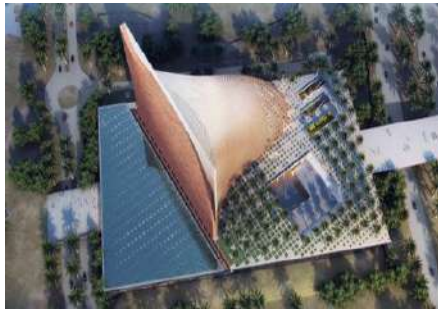

CREEK MOSQUE DUBAI, UAE
RAW-NYC ARCHITECTS. DESIGN DIRECTOR: RAYA ANI

Creek Mosque design gives an iconic contemporary perspective of its Islamic, Arabic and Dubai heritage in its dramatic fusion of the sea shell and the dome shape. The shell structure houses the main prayer hall that accommodates 7,500 prayers. The overall shape of the mosque has a higher point on the North side, to the right of the Mihrab wall, referencing the height of minarets typically used in traditional Mosque designs. The peak point of the structure references the high point of the Minaret.



AL KHOR MASTER PLAN DOHA, QATAR
RAW-NYC ARCHITECTS. DESIGN DIRECTOR: RAYA ANI

The 5.5 million square meter master plan brings global vision exclusive to the environmental character of Al Khor. It is both a paradigm for clean, integrated and sustainable future living and a rare opportunity to create a vibrant mixed-use neighborhood with easier access to the waterfront. This is achieved by combining compact, dense and vibrant environments with open green spaces. The site is designed as four distinct parts that are stunningly integrated into a unified, coherent, and organic whole.

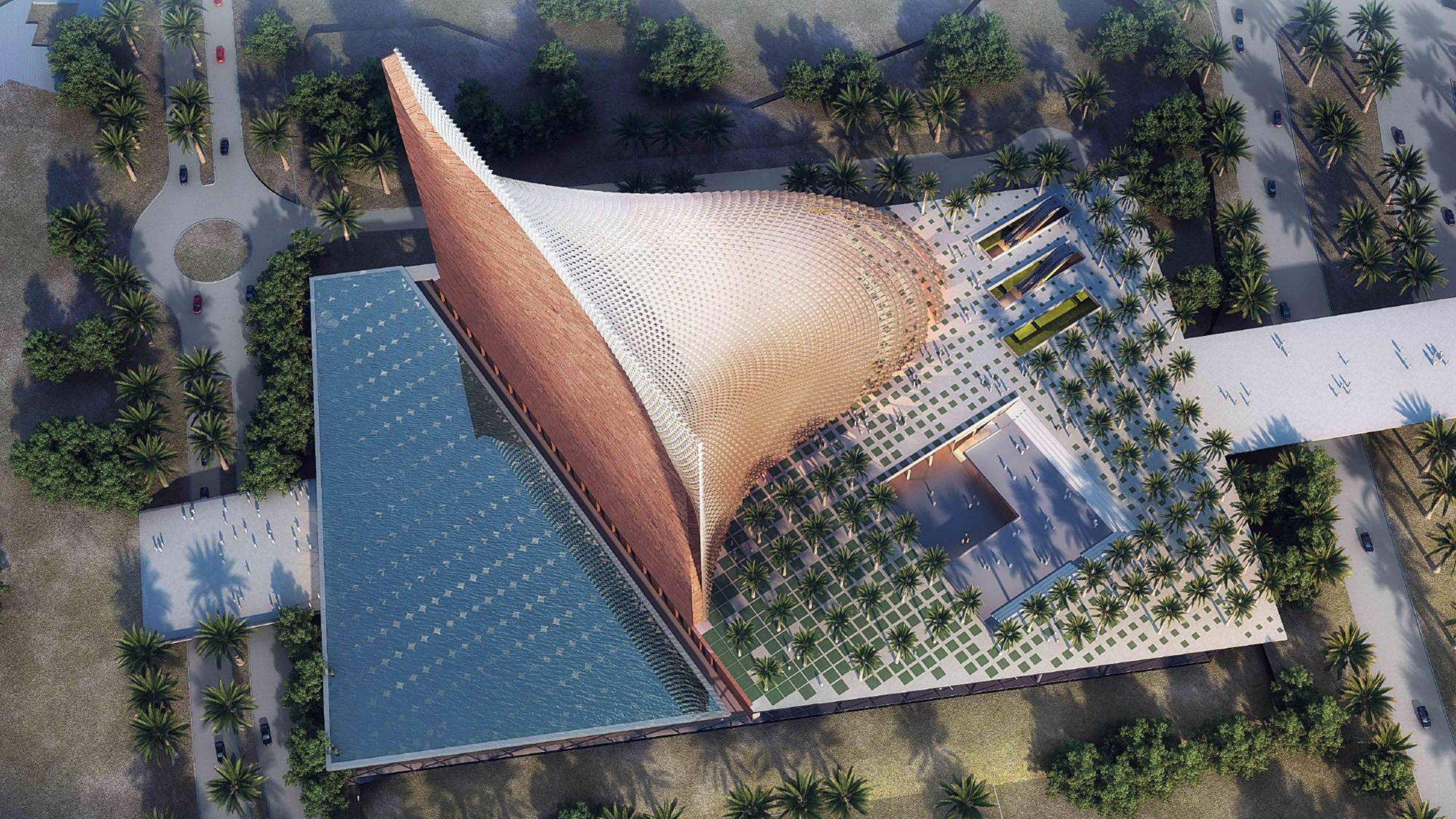



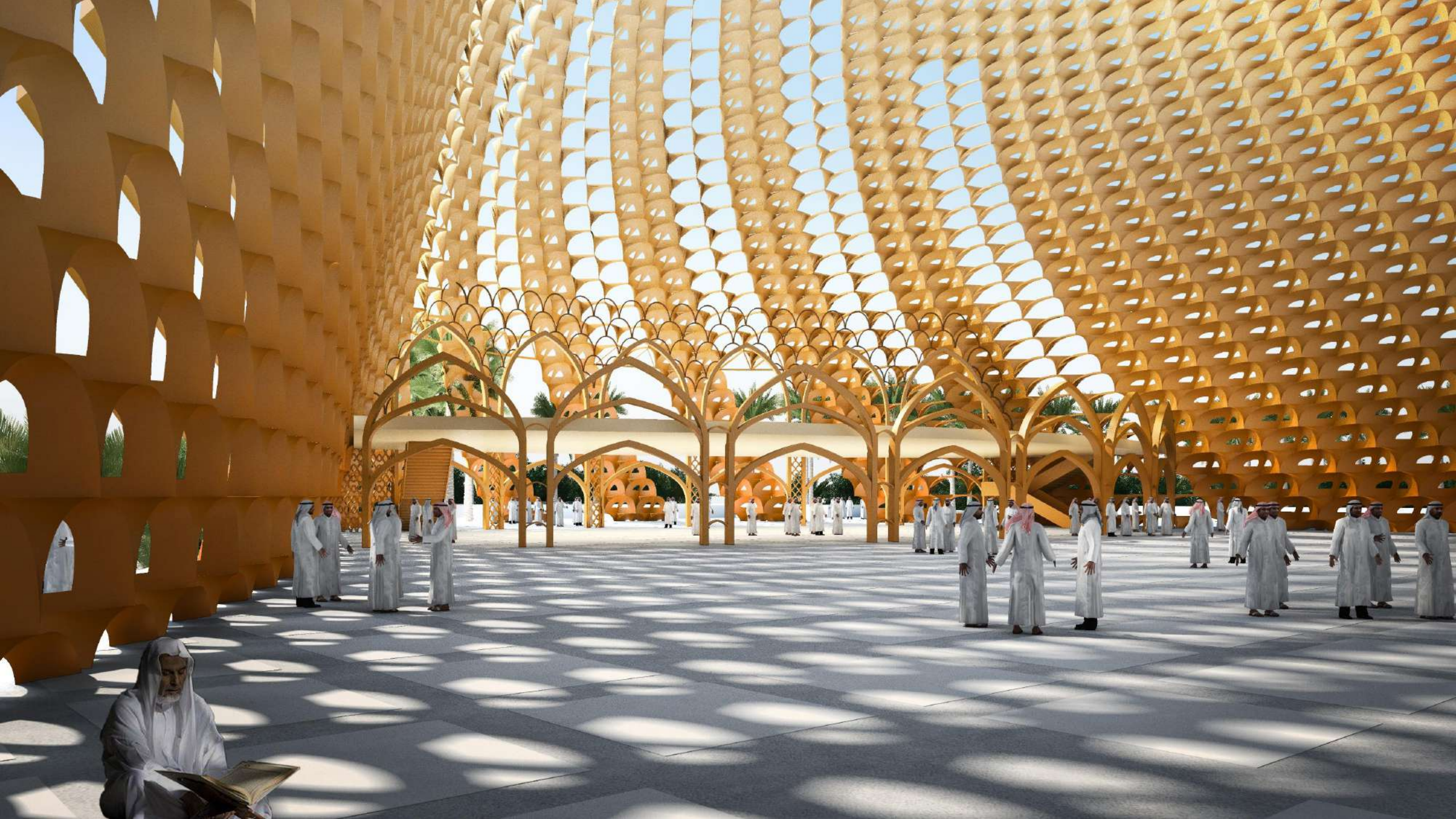

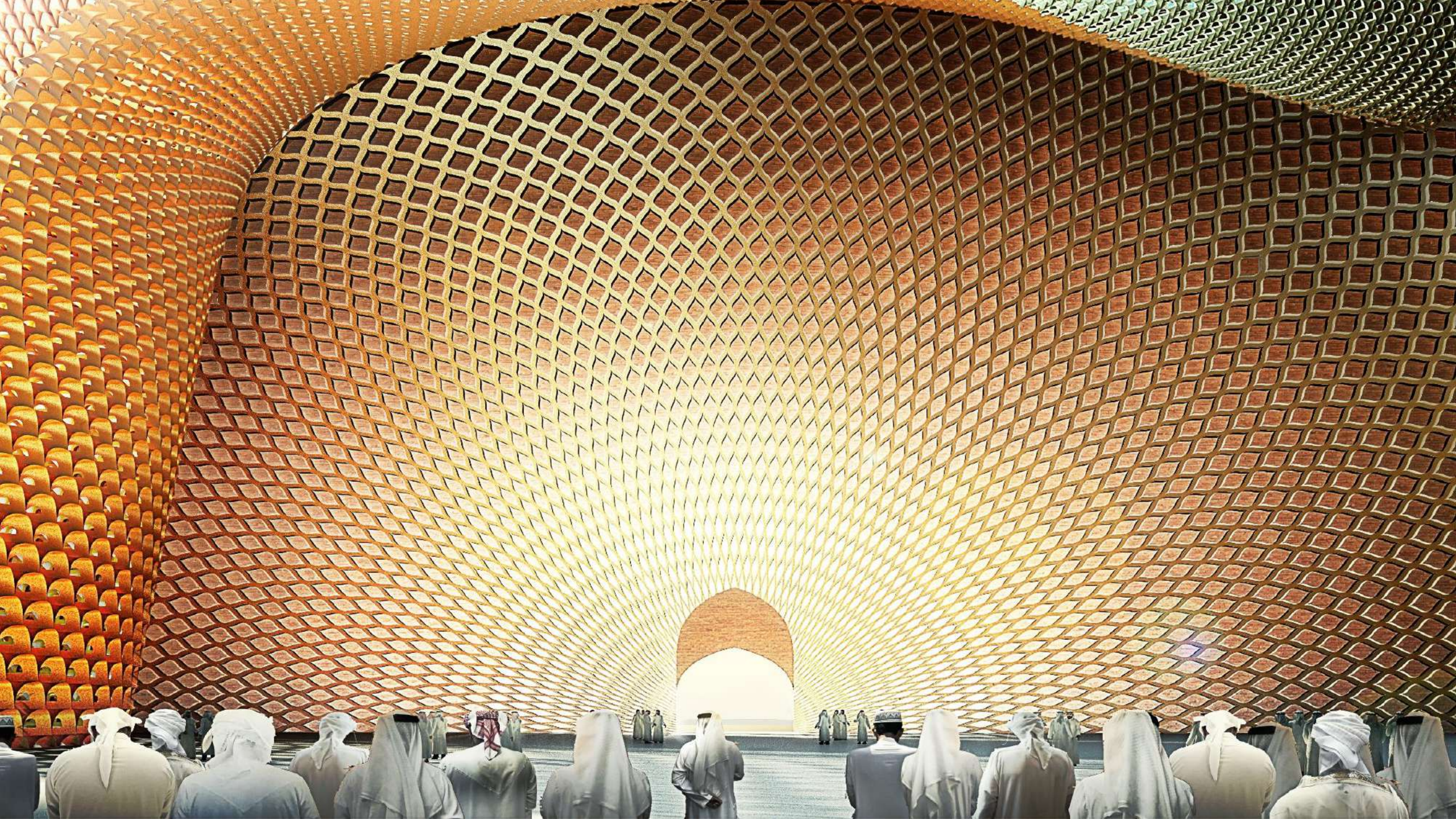

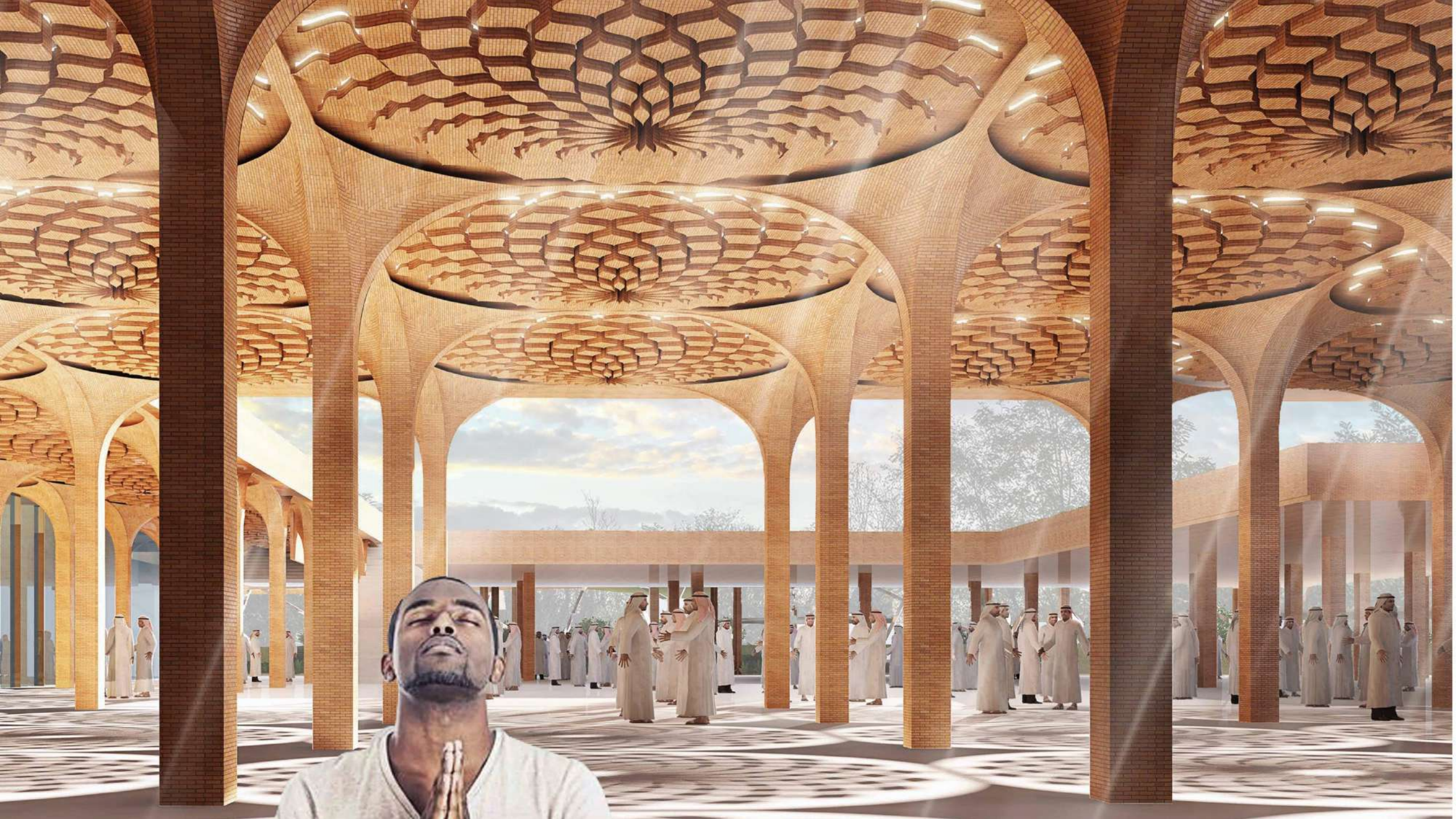



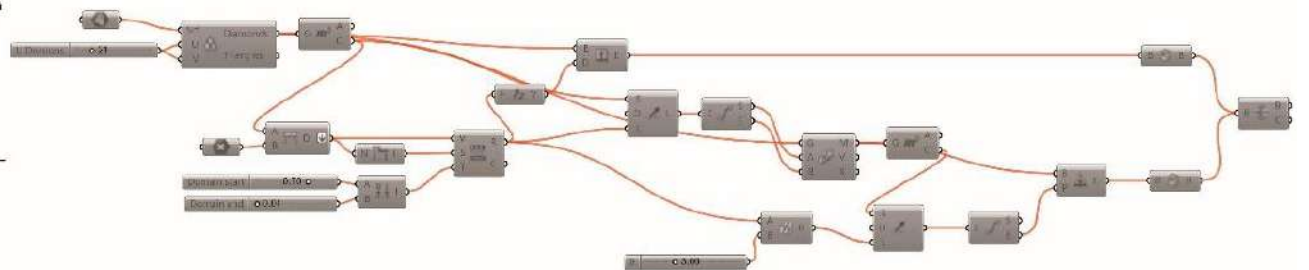
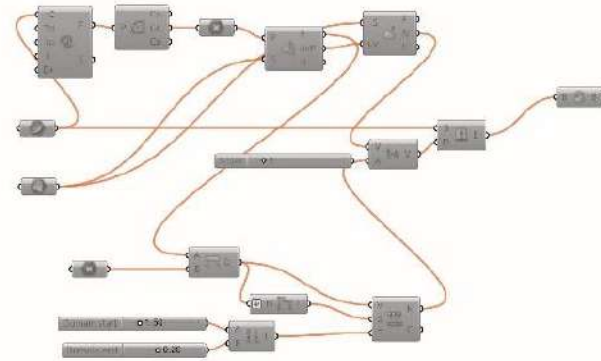
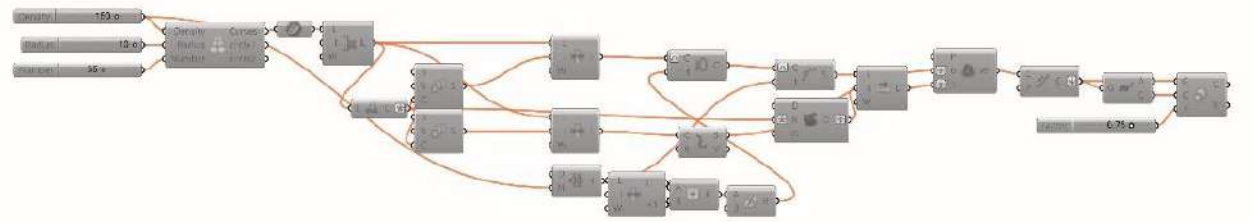
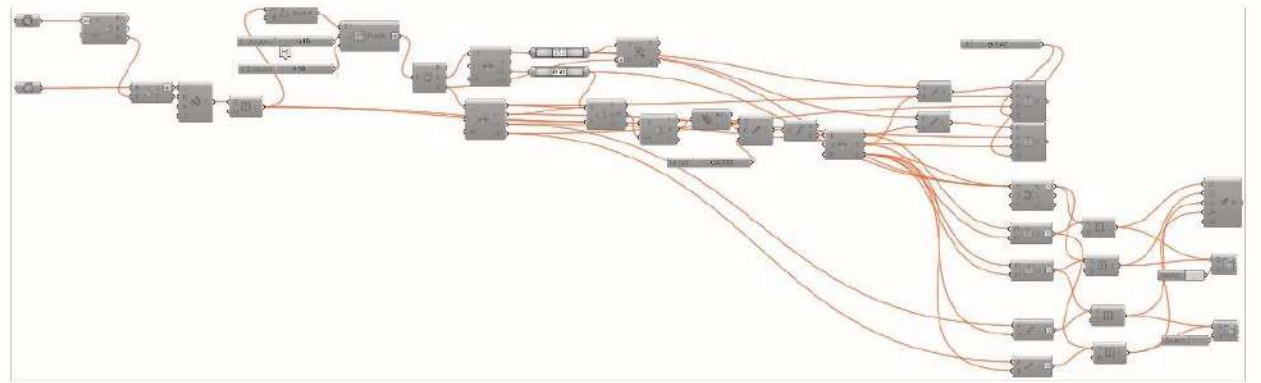
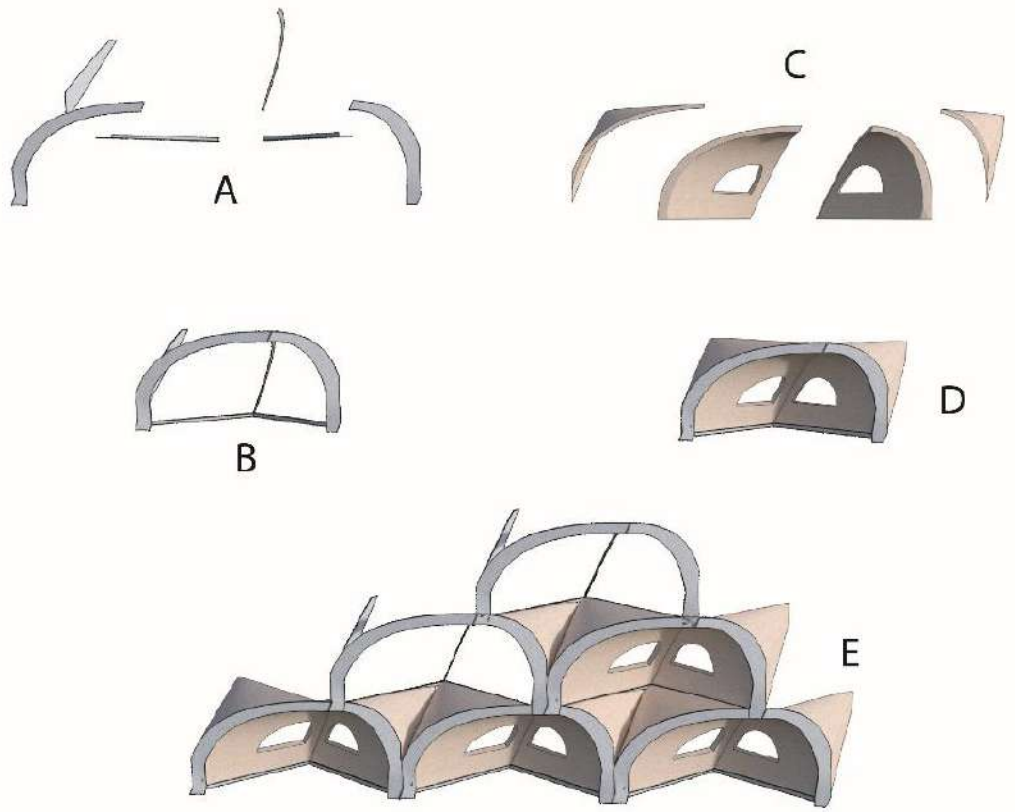

PARAMETRIC TOOLS TO DEVELOP DESIGN

Parametric tools used to explore the geometry and the structural design of the Shell.

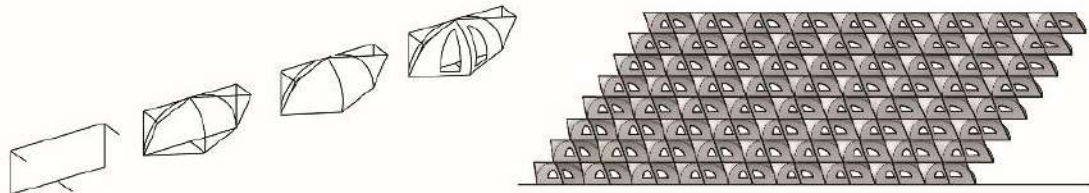

LOBBYING

OUTREACH

EMPOWERMENT

DESIGN

CONSTRUCTION

SUPERVISION

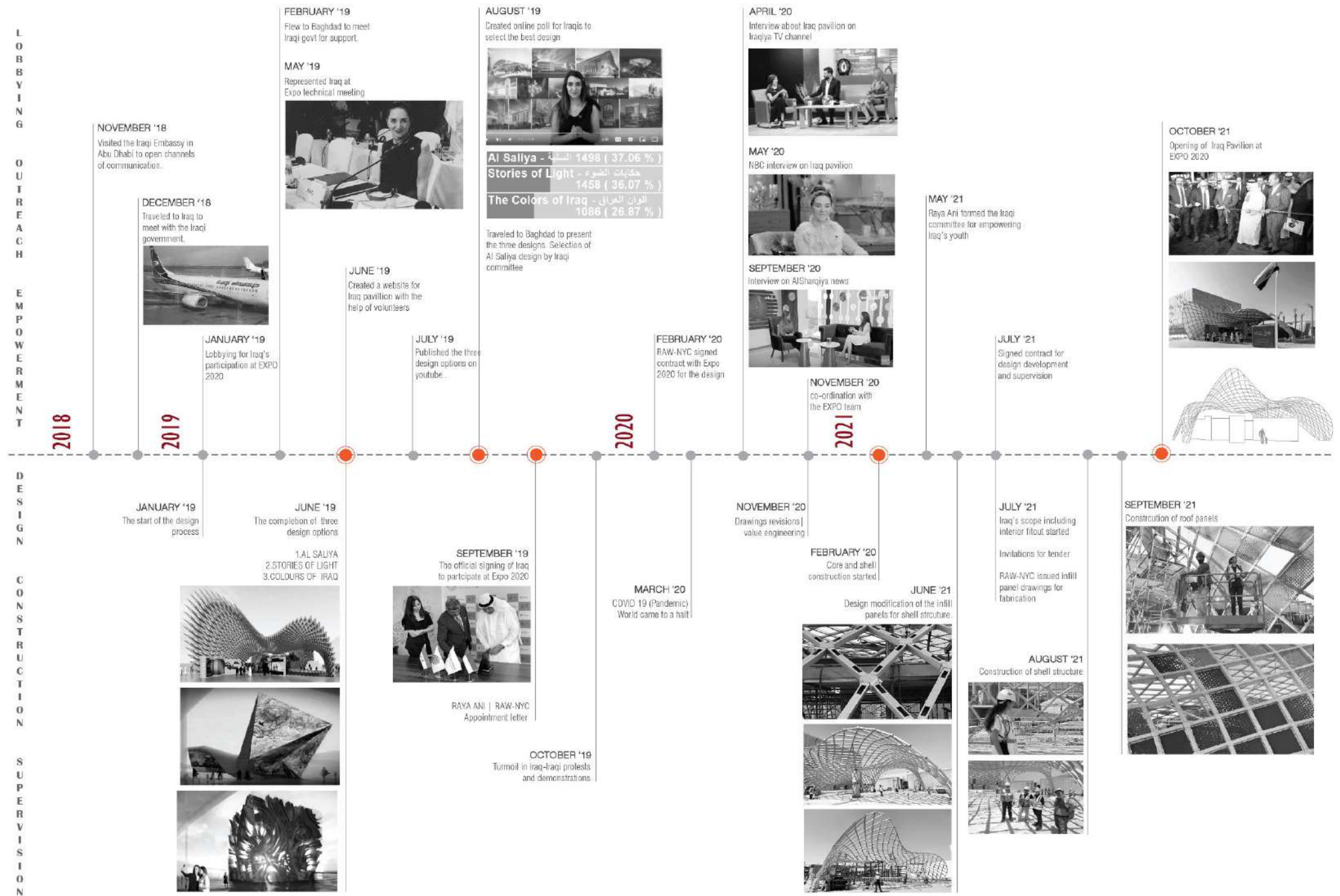

SHELL STRUCTURE

The fishing net form symbolizes the catching of future opportunities for a new Iraq in a global context.

MEDIA WALLS

The walls outline the path of the Tigris and Euphrates rivers showcasing through its content Iraq's history

IRAQ MAP

Iraq's map outlined on the floor creating a journey of traveling on the land of Iraq along the two rivers.

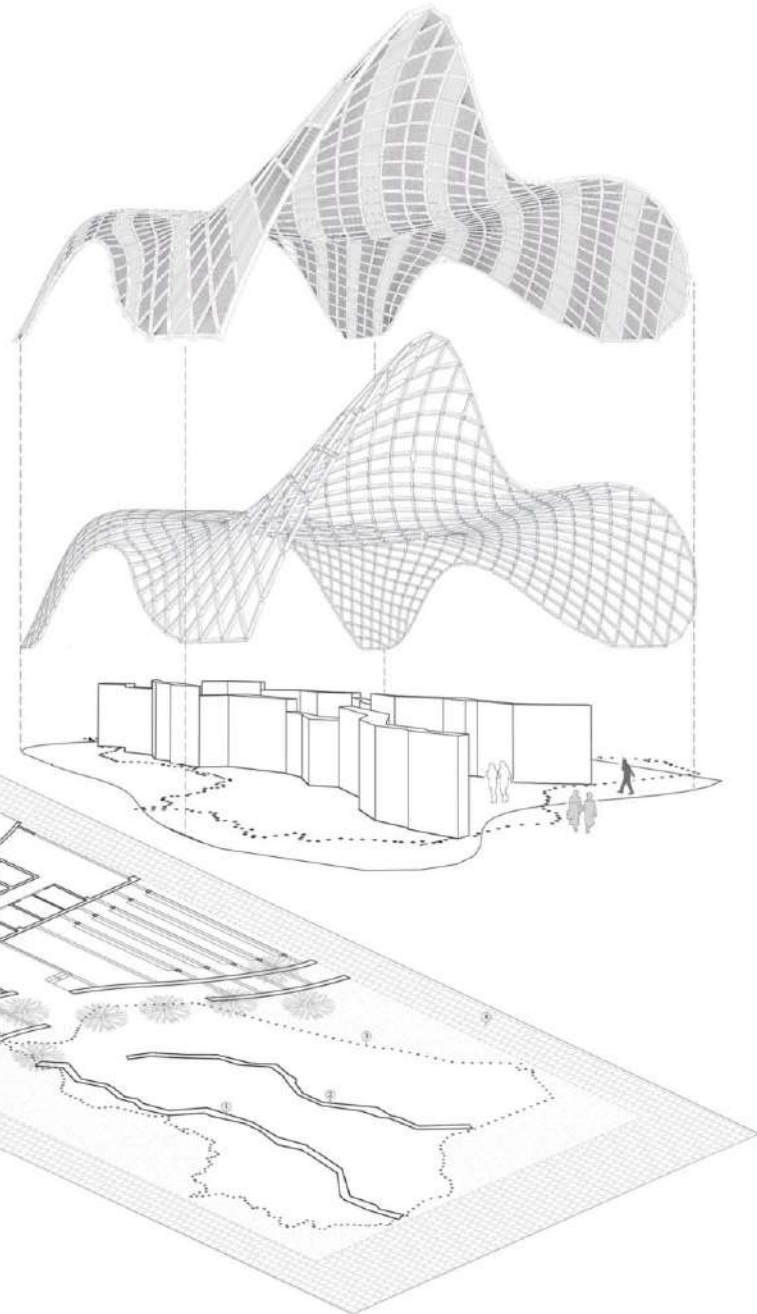

- 1. Tigris River - Media wall
- 2. Euphrates River - Media wall
- 3. Iraq map outline
- 4. Setback area

EMPOWERING IRAQI TALENTS

Showcasing Iraqi talents through art, calligraphy, literature and poetry.

Housing Art Exhibition
Displaying Historical Artifacts

EMPOWERING THE PUBLIC

Theater space dedicated for lectures, performances, events, and activities to highlight the achievements of Iraqis.

SYMBOLIC REFERENCES

The symbolic use of 7 palm tree imprints on the concrete walls has its significance in Mesopotamian culture.

7 Palm trees welcome the visitors. Palm trees are one of the oldest trees well known in Babylon, Iraq, 4000 B.C celebrated for their strength and majesty.

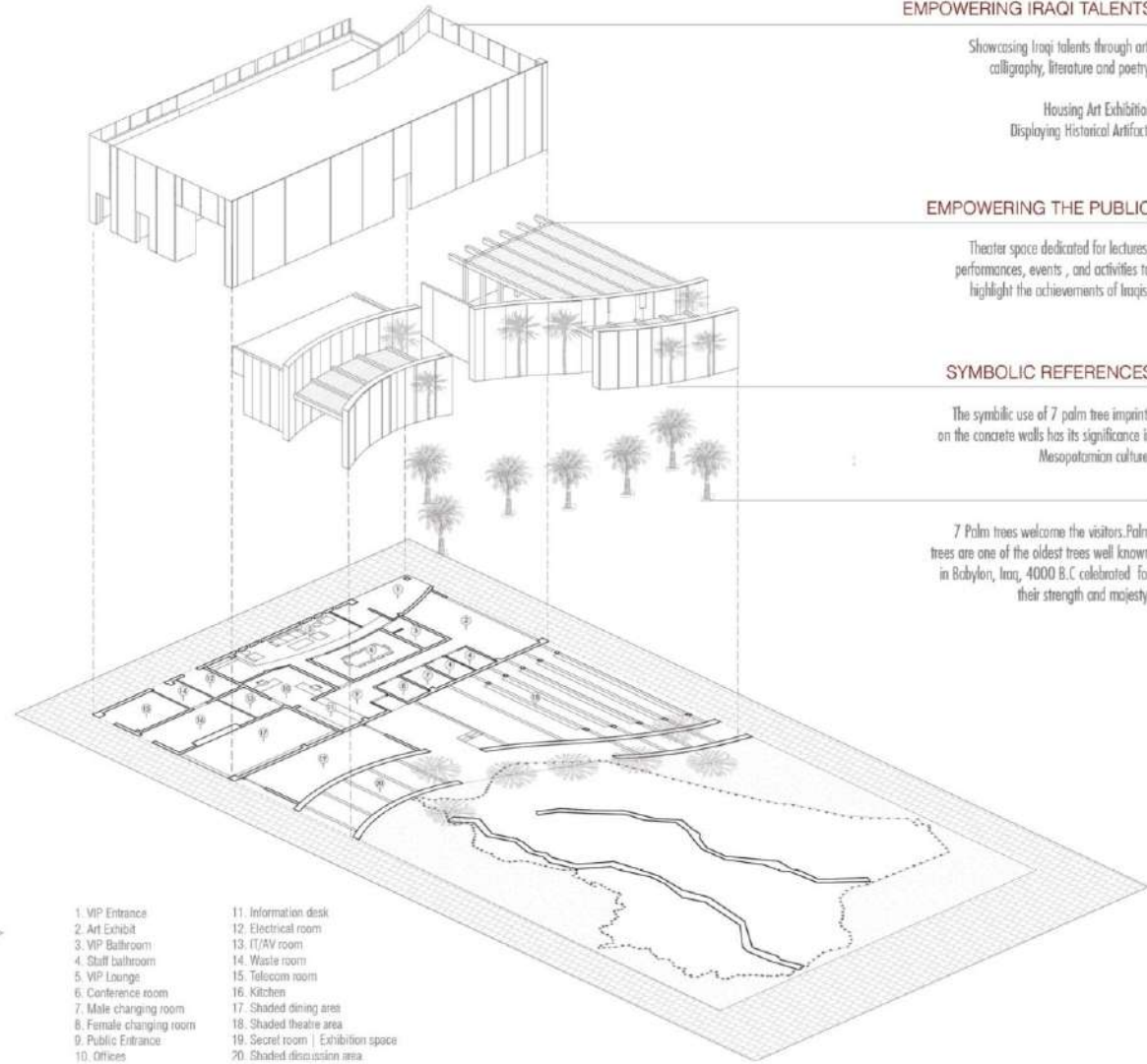

- 1. VIP Entrance
- 2. Art Exhibit
- 3. VIP Bathroom
- 4. Staff bathroom
- 5. VIP Lounge
- 6. Conference room
- 7. Male changing room
- 8. Female changing room
- 9. Public Entrance
- 10. Offices
- 11. Information desk
- 12. Electrical room
- 13. IT/AV room
- 14. Waste room
- 15. Telecom room
- 16. Kitchen
- 17. Shaded dining area
- 18. Shaded theatre area
- 19. Secret room | Exhibition space
- 20. Shaded discussion area

CONCEPT

HISTORY



Map of Iraq with the Tigris and Euphrates rivers



The media walls outlining the path of the two rivers

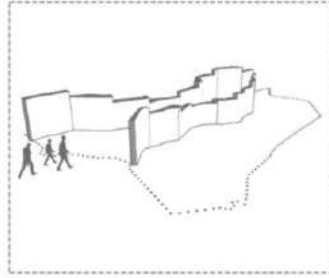

The journey of travelling on land along the rivers

CULTURE



Al Saliya (traditional fishing net used in Iraq)

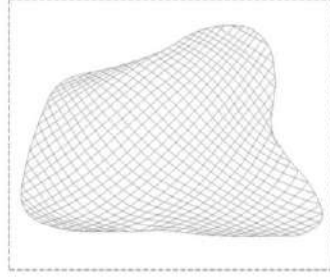

Al Saliya was translated into a shell structure

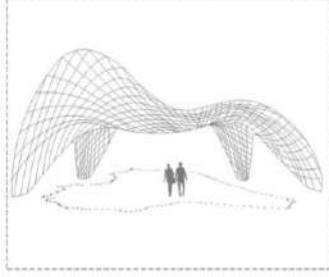

Al Saliya structure shading the main outdoor space

OPPORTUNITY

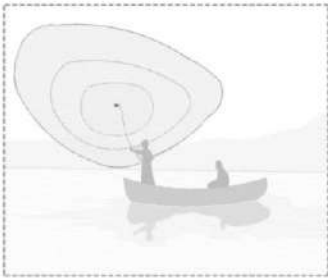

Al Saliya (symbol of wealth, wisdom and goodness in Mesopotamian culture)

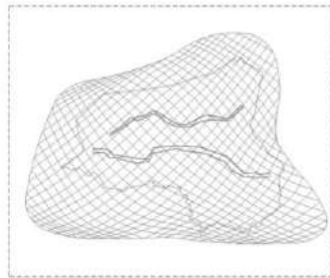

The layering of the shell structure, Iraq's map and two media walls

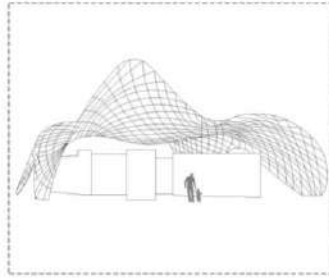

The Pavilion with the two media walls and shell structure above

SUSTAINABILITY

SOLAR POTENTIAL

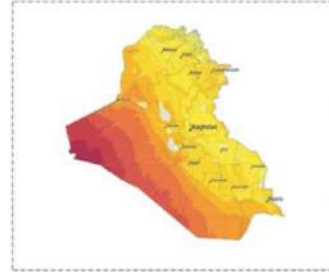

Map showing the Photovoltaic power potential of Iraq

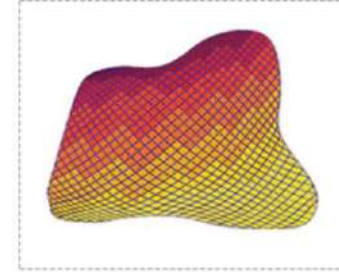

Photovoltaic map superimposed on the shell structure

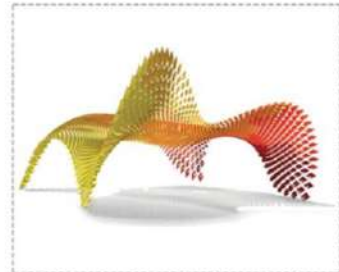

Al Saliya structure showing color variations of Iraq's solar potential

PASSIVE COOLING

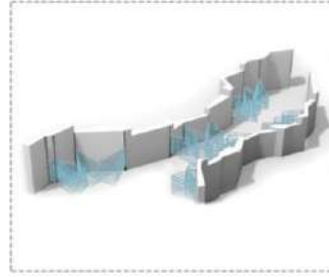

Vertical misting fans between the two media walls

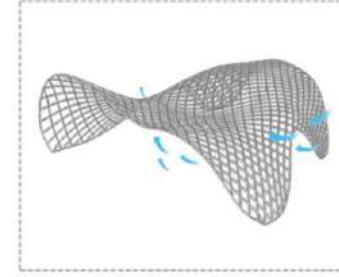

Shell openings allow for natural air flow and ventilation

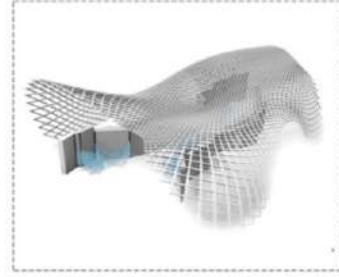

The combination of passive cooling, active cooling and natural ventilation

SHADING



The infill panels of the shell structure

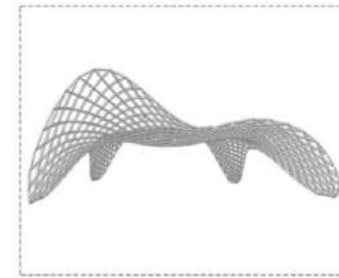

The frame of the shell structure

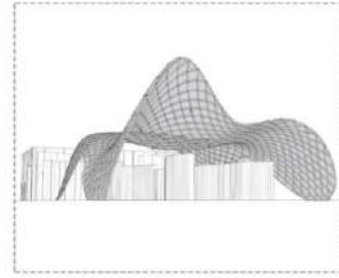

The frame and the infill panels of the shell structure

EMPOWERMENT

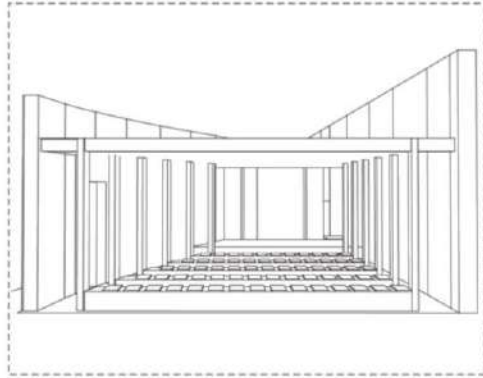

Open theater for lectures, performances and events

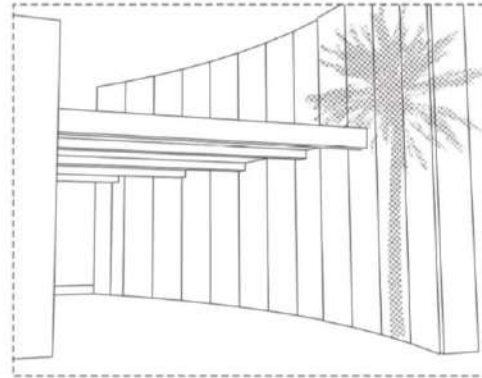

Shaded outdoor Discussion area

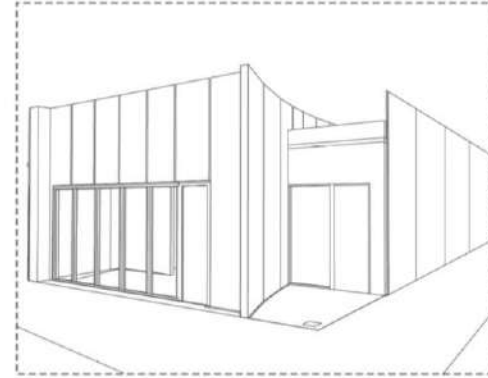

Art Exhibition spaces

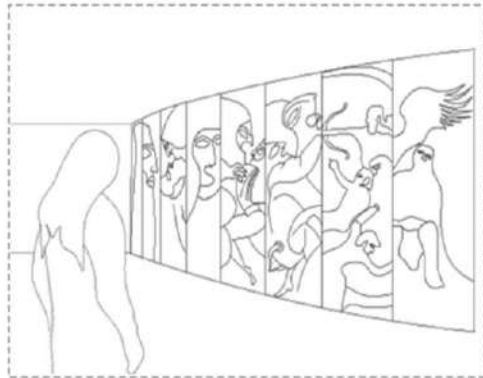

The Epic of Gilgamesh projected on the wall as an abstract painting

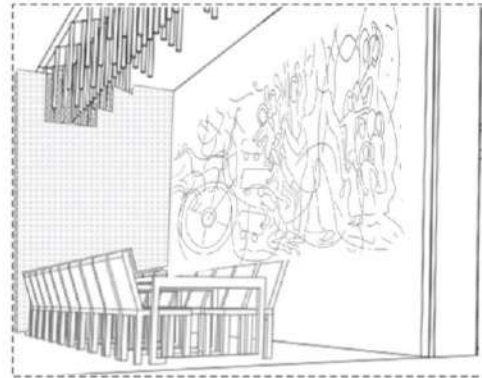

The dining room experience highlights Iraq's culture in food and story telling

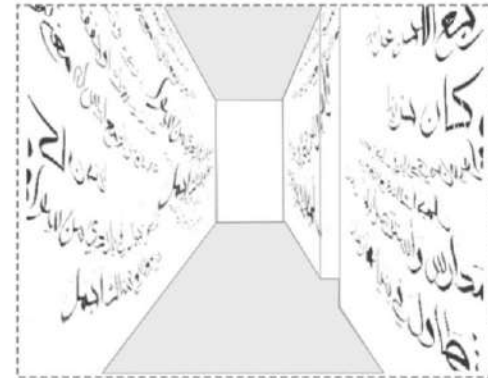

Point brush the poems of the most influential Iraqi poets in calligraphy by an Iraqi artist

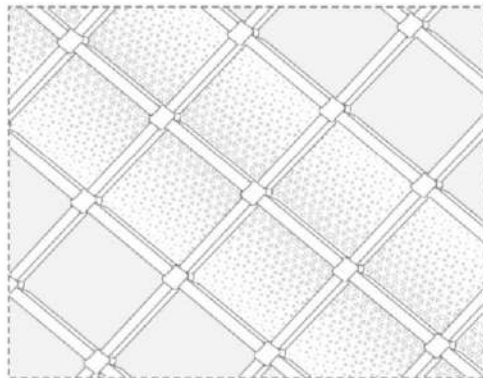

The general pattern inspiration from Palm fronds and the perforation pattern inspired by basket weaving



The imprints of palm trees on the curved wall of the VIP room



Palm tree inspiration in the theater, discussion area and throughout the pavilion





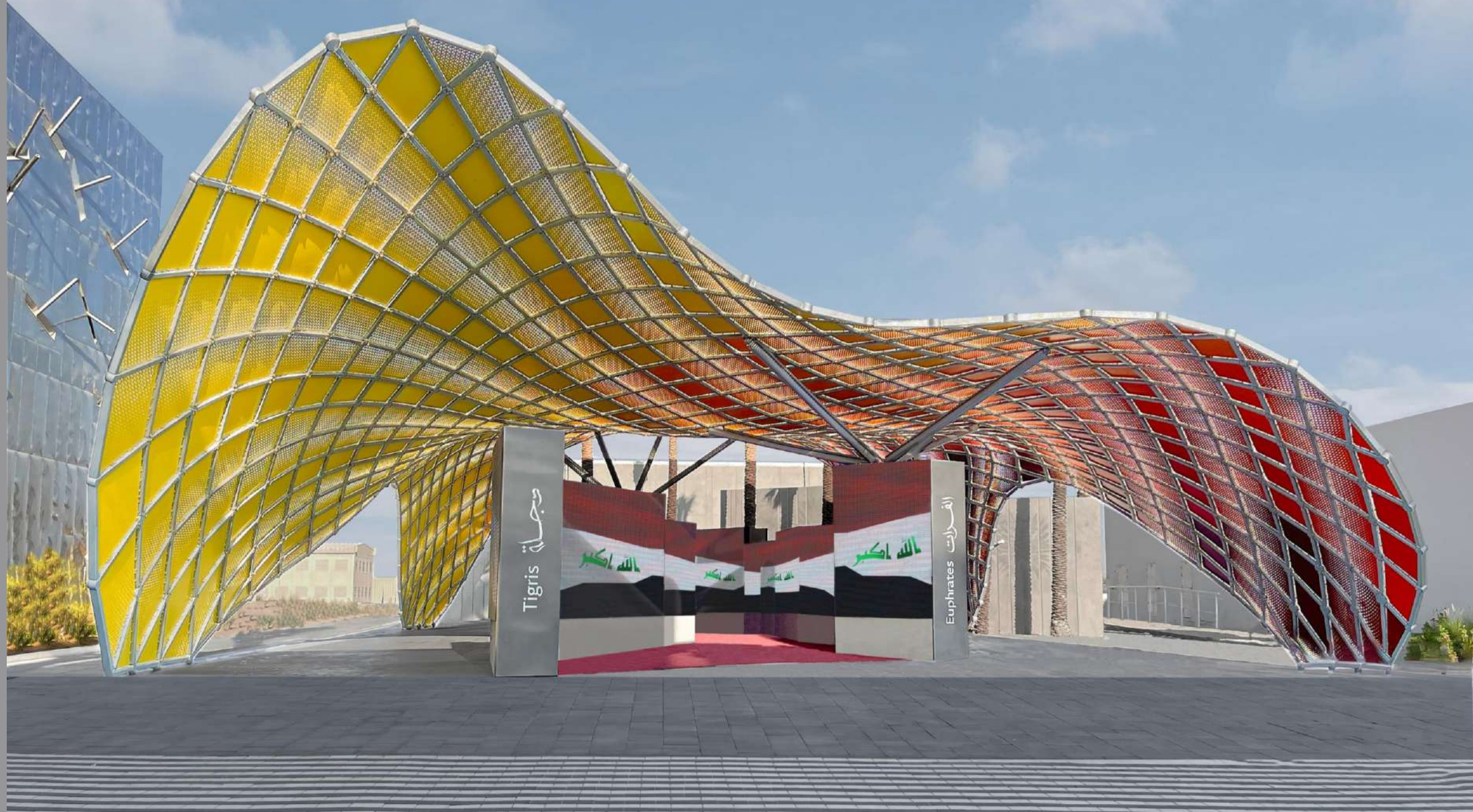

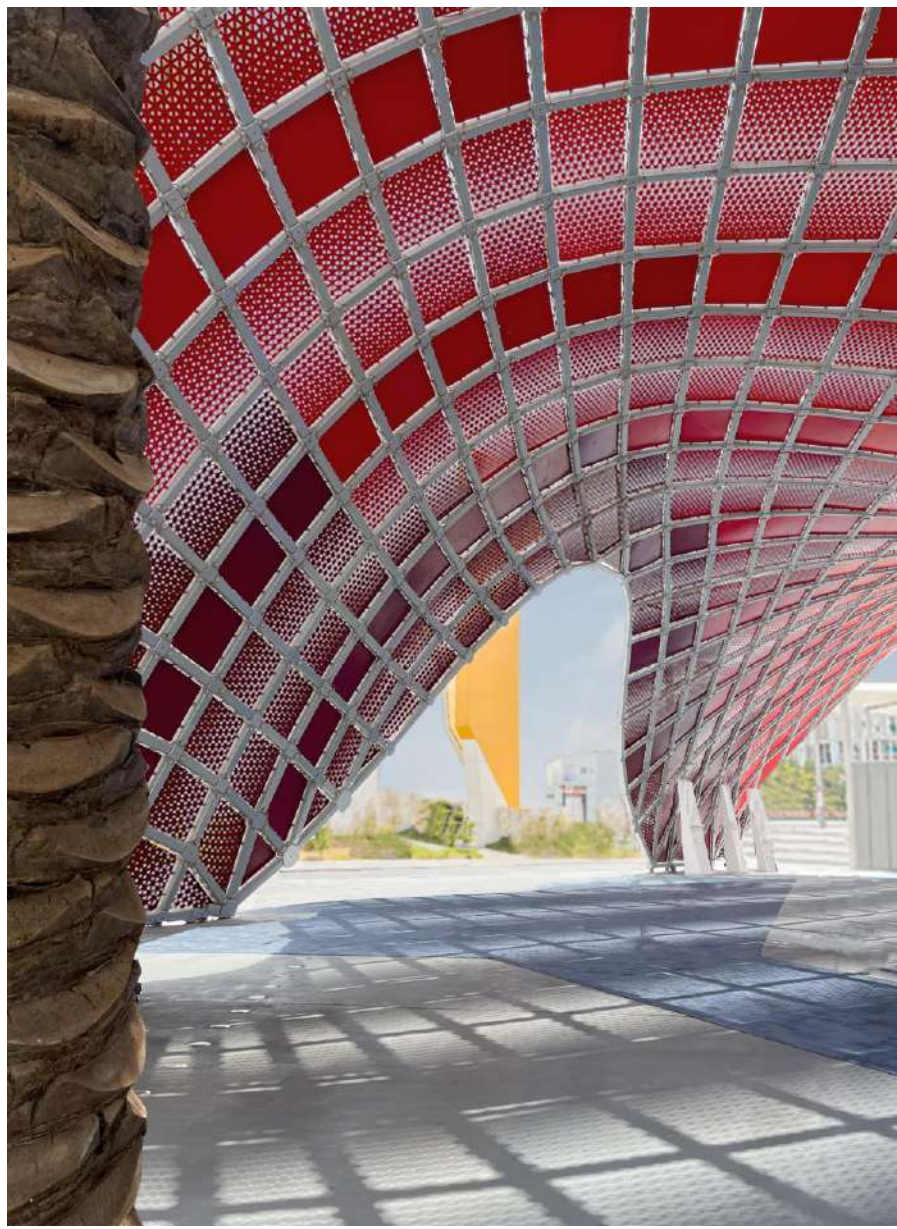

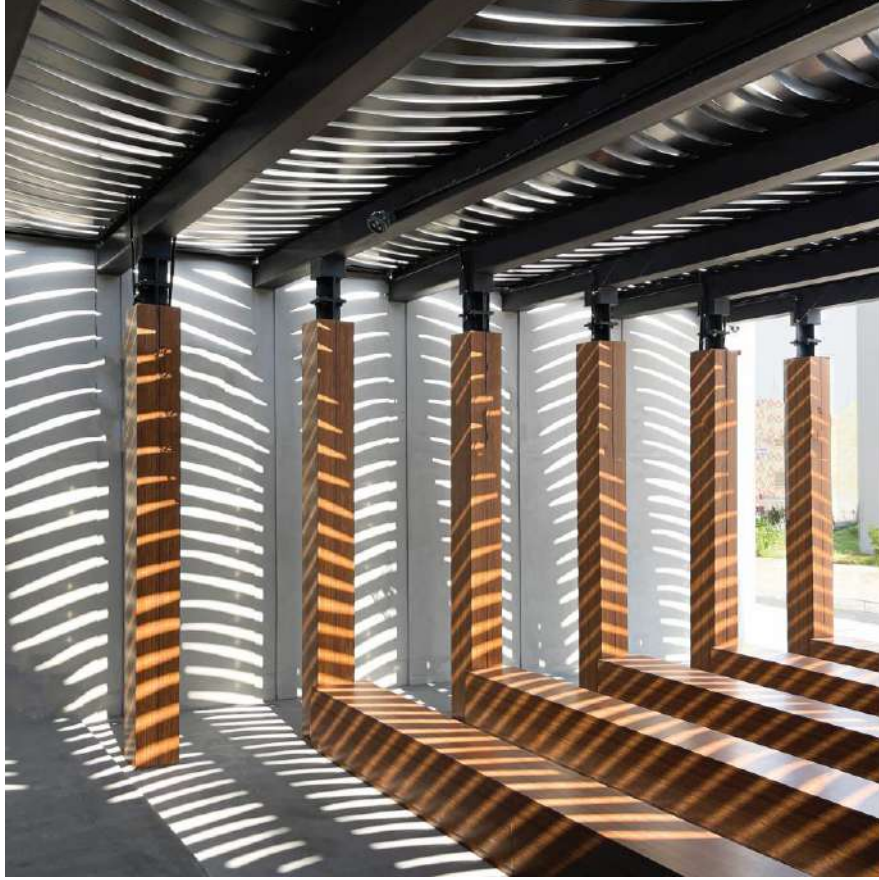

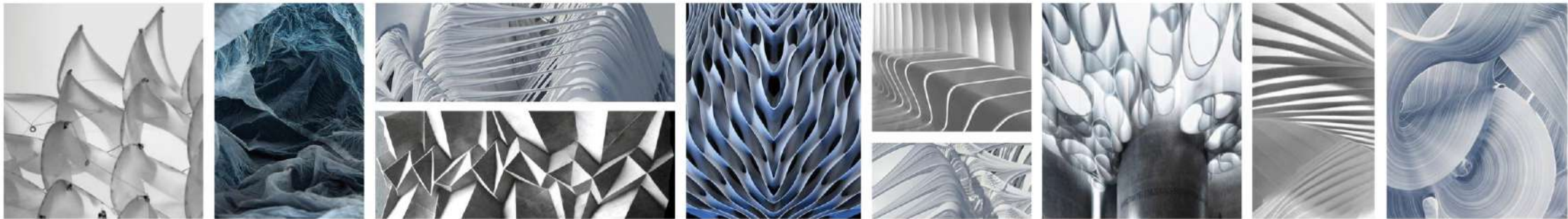

IMAGE SOURCE - PINTEREST

INNOVATION

RAW-NYC ARCHITECTS. DESIGN DIRECTOR : RAYA ANI

RAW-NYC together with the client will outline a few innovation strategies; how to create value for the client and potential end users; how the company will capture this value, and which types of innovation to pursue. We will articulate the innovation strategy with you - Our goal is to align the strategy selected with your overall business plan. Together we will discuss how we will translate this into a design vision that will be born out of what was outlined first.

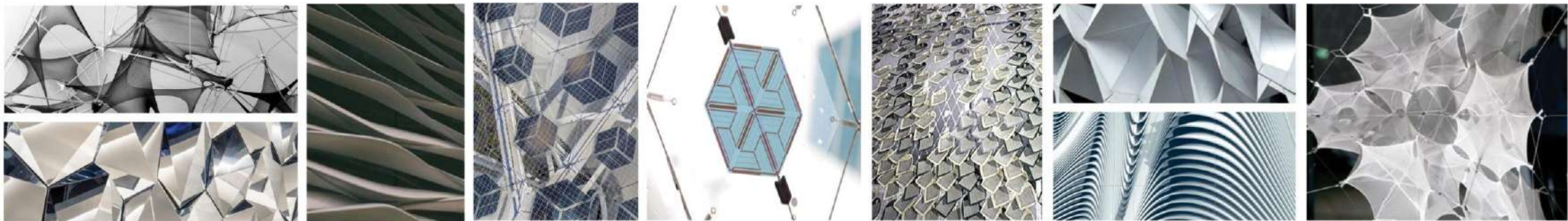

IMAGE SOURCE - PINTEREST

SUSTAINABILITY

RAW-NYC ARCHITECTS. DESIGN DIRECTOR : RAYA ANI

At RAW-NYC, we strive for sustainability by integrating environmental, social, and economic strategies from the initial phase through to the end of buildings' life. We aspire to transition to a sustainable, CIRCULAR ECONOMY through design. We always think of the value that it offers and we believe the value has to be greater than what it took to make it. We are committed to driving transformational change while promoting a healthy lifestyle in buildings.

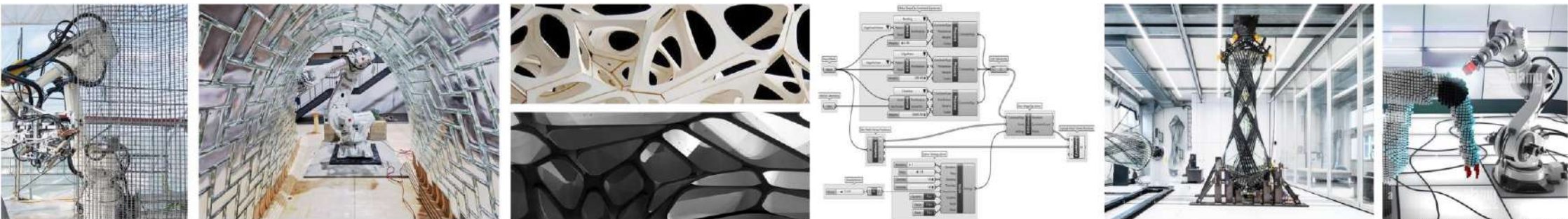

IMAGE SOURCE - ABO ROBOTICS, ARCHIDAILY, PINTEREST

TECHNOLOGY

RAW-NYC ARCHITECTS. DESIGN DIRECTOR : RAYA ANI

At RAW-NYC, we believe designs are better informed and strengthened by EMBRACING technology and data, thus unleashing creativity. We explore potential solutions and generate numerous design alternatives. Technology helps us strengthen and support our architectural design. We aim to use materials and technologies for better buildings that are fundamentally sustainable. We leverage business intelligence tools to transform the process and engage the client from the beginning up to construction completion.

RAYA ANI | RAW-NYC ARCHITECTS

THANK YOU

